

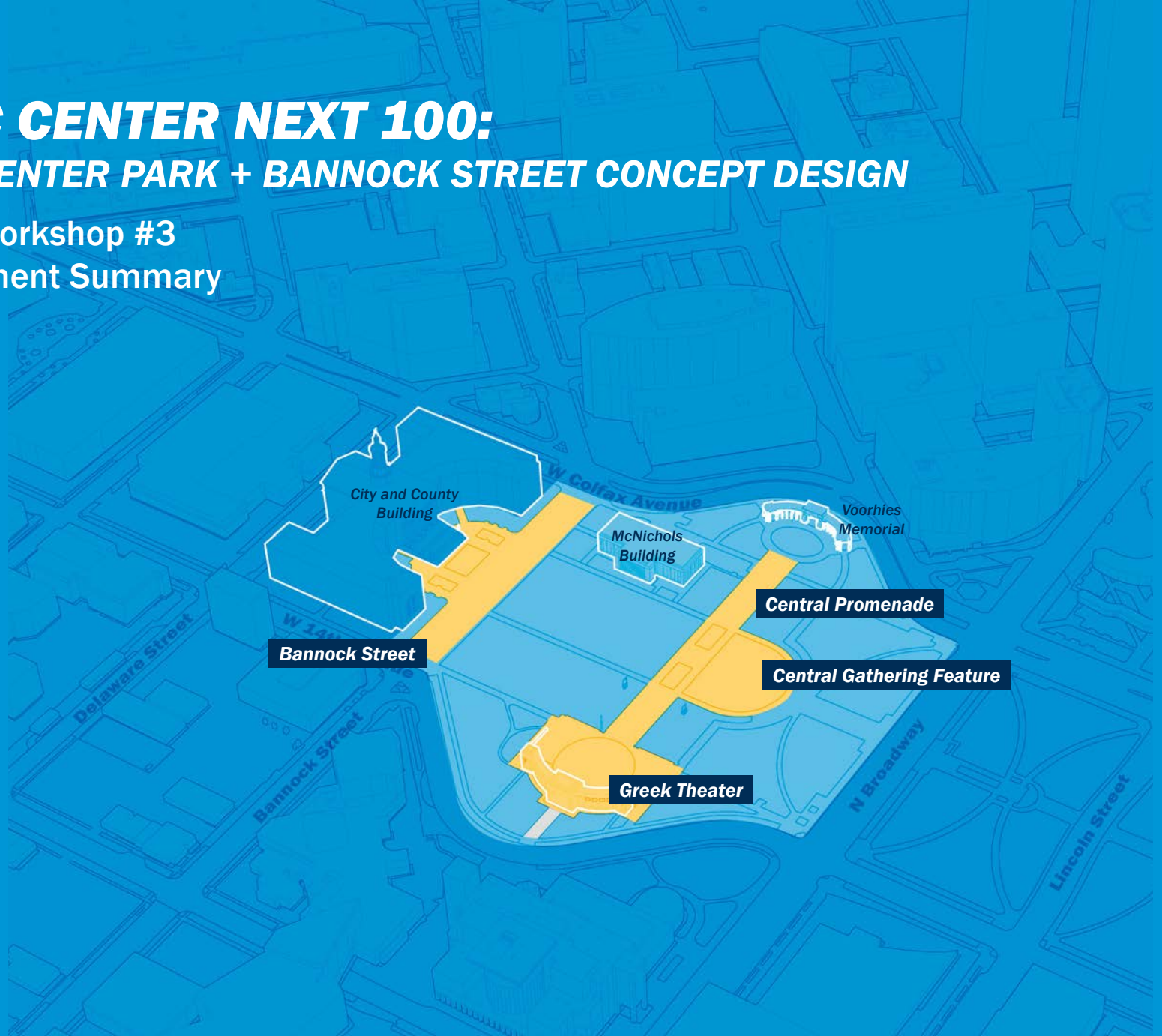

# **CIVIC CENTER NEXT 100: CIVIC CENTER PARK + BANNOCK STREET CONCEPT DESIGN**

**Public Workshop #3  
Engagement Summary**

**Fall 2021**



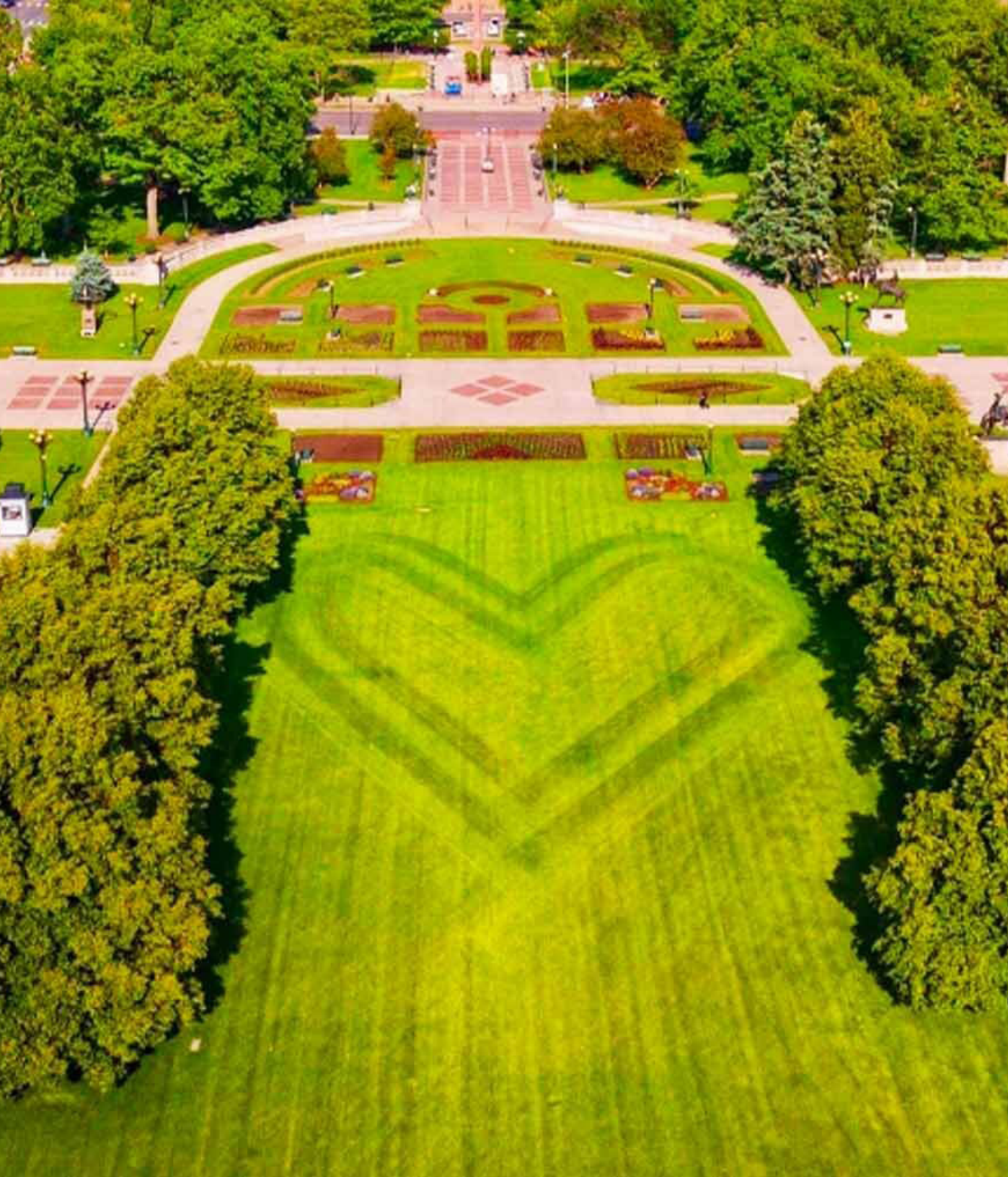

## ***CONTENTS***

1. Project and Engagement Overview
2. Concept Options Feedback Summary
3. Key Takeaways Park-Wide
4. Frequently Asked Questions (FAQs)

# ***1. PROJECT AND ENGAGEMENT OVERVIEW***

# Project Vision

## **CIVIC CENTER NEXT 100: Civic Center Park + Bannock Street Concept Design**

### **What do you imagine for the next 100 years of Civic Center?**

The world’s greatest communities are defined by timeless public spaces where people gather, connect and belong. Now more than ever, active spaces are critical to the mental and physical health of a city’s residents as well as its economy. For Denver, our crown jewel is Civic Center.

Located at the heart of the city and surrounded by many of our key civic and cultural institutions, Civic Center has served as Denver’s most significant gathering spot for cultural events, festivals, and First Amendment rallies for over 100 years. As Denver’s first National Historic Landmark we must honor Civic Center’s history as we envision its future.

‘Civic Center Next 100’ takes the 2005 Civic Center Master Plan and brings it to life for the Denver of today and the generations to come.

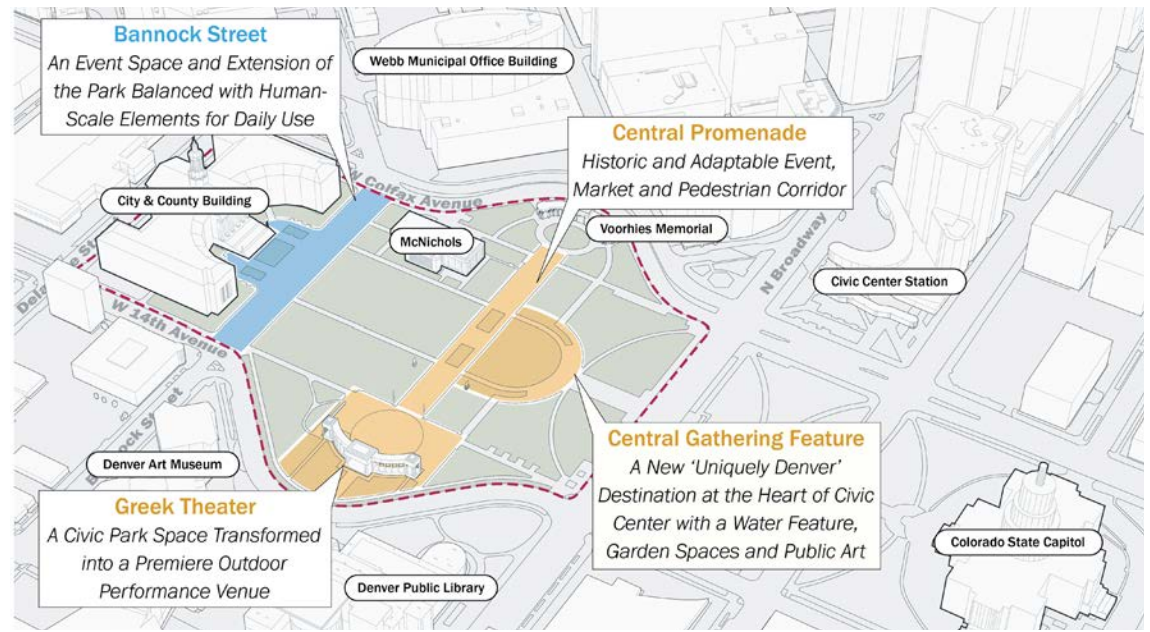

### **Four Integrated Projects**

Improvements to Civic Center will catalyze new activity and animate this park the heart of Denver. The transformation of four key areas will fulfill past community-driven planning visions and elevate Denver’s first National Historic Landmark for the next 100 years by providing new energy, world-class performances, and events.

### **Concept Design Timeline**



# Project Principles



**Principle 1:**  
**Enliven Civic Center as a place for people.** Make it active, engaging, welcoming and comfortable to everyone (children, residents, visitors, tourists, workers) every day.



**Principle 2:**  
**Elevate Civic Center to form a prominent destination** centered around distinct cultural and community anchors.



**Principle 3:**  
**Celebrate the historic significance** of the Civic Center landmark.



**Principle 4:**  
**Incorporate resilient design** to ensure Civic Center is a model for successful urban ecology, sustainability and long-term vitality for the next 100 years.



**Principle 5:**  
**Unify Civic Center** by implementing city-wide connectivity visions to link to surrounding cultural, recreational and civic spaces and reinforcing physical and visual connections to the surrounding district.

# PUBLIC WORKSHOP #3 Engagement Sessions

## Stakeholder Committee Meetings

---

Sept 21, 2021 - Technical Advisory Committee (TAC)

Sept 21, 2021 - Stakeholder Advisory Committee (SAC)

## Focus Group Meetings

---

Sept 21, 2021 - Operations and Management  
Focus Group

Sept 22, 2021 - Community Connections Focus Group

Sept 22, 2021 - Greek Theater Focus Group

Sept 22, 2021 - Daily Activation Focus Group

Sept 23, 2021 - Events Focus Group

## Past Engagement Summaries

---

Engagement Summary Document from  
Public Workshop #1

Engagement Summary Document from  
Public Workshop #2

**Workshop #3 concluded  
public outreach for the  
Civic Center Next 100 Concept  
Design Project!**

**The total project resulted in:  
2,593 survey responses  
3,265+ points of public feedback  
Across 3 workshop sessions**

**778 Points of Feedback**  
for 'Civic Center Next 100' Workshop #3

**669 Survey Responses**

---

## Attendee Counts

Operations and Management and  
Technical Advisory Committee (TAC) Meeting **29**  
Stakeholder Advisory Committee (SAC) Meeting **21**  
Community Connections Focus Group **10**  
Daily Activation and Events Focus Groups **18**  
Greek Theater Focus Group **10**  
Civic Center Conservancy **15**  
Public Workshop #3 **42**  
Public Workshop Video Recording Views **95+**  
Online Surveys **669**

## ***2. PREFERRED CONCEPT FEEDBACK SUMMARY***

At Public Workshop #3, the project team shared the feedback from Public Workshop #2 and presented a preferred concept design for the Greek Theater, Central Promenade, and Bannock Street. The team presented a landscape framework plan for the Central Gathering Feature. Feedback was gathered at the Public Workshop as well as through an online and paper survey.

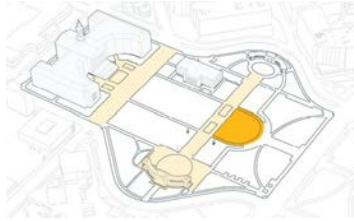

# Central Gathering Feature

**A New, 'Uniquely Denver' Destination  
Within Civic Center with a Water  
Feature, Garden Spaces and Public Art**

## OBJECTIVES

- Complete the original vision for the park
- Honor the historic City Beautiful aesthetic with a contemporary expression
- Incorporate water and gardens per the Master Plan
- Create a magnetic attraction within the center of the City
- Celebrate the historic civic and cultural geometric axes
- Represent historically marginalized voices
- Incorporate joy, delight, and new perspectives
- Draw diverse visitors of all ages 365 days-a-year
- Create a flexible space to work with rallies, festivals, and programming



# Central Gathering Feature

## Previous Workshop Summaries

### Workshop #2 Concept Options

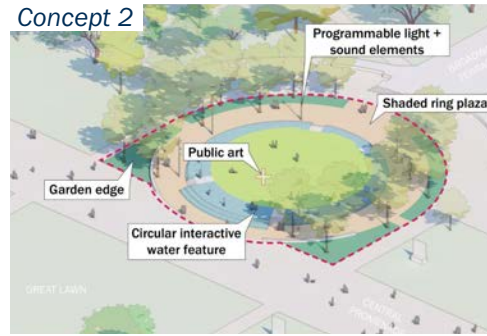
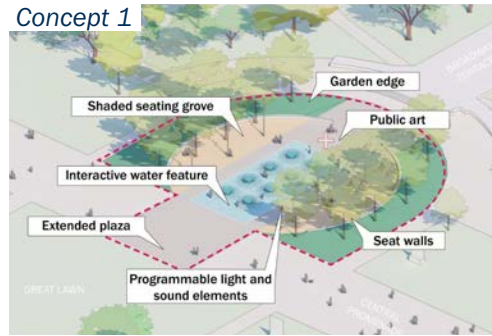

**Community Feedback from Workshop #2** expressed a desire for unique features in the selection of the water feature, iconic sculpture, gardens, and lighting to create a space that celebrates Denver and draws people into the park. The design should complete the historic park vision, maintain the view corridors to the State Capitol and City and County Building and highlight historically marginalized voices. Many comments supported providing trees and places to sit in the summer heat. This feedback led to the preferred concept plan images below.

### Workshop #3 Landscape Framework Plan



# Central Gathering Feature

## Survey Results Workshop #3

**What most excites you about the final Central Gathering Feature vision?  
(Select all that apply)**

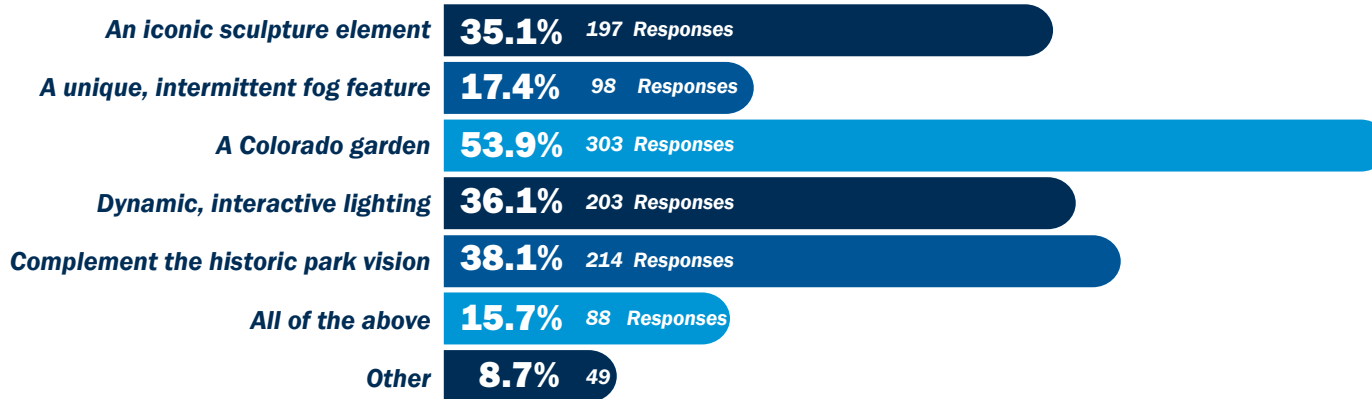

### Feedback Themes

- » Desire to integrate new narratives by engaging historically marginalized voices — indigenous representation was repeatedly requested
- » Repeated calls for more shade from new trees and garden displays
- » Desire to honor the historic design vocabulary and enhance the axial views
- » Concern about water waste and appropriateness of a fog fountain in Denver’s climate
- » Desire for a sculpture that is directly engaging — interactive or immersive
- » Need for a new process that includes an integration of a call for artists — an international competition that is also open to local artists



An iconic sculpture element and unique, intermittent fog feature



A Colorado garden that complements the historic park vision

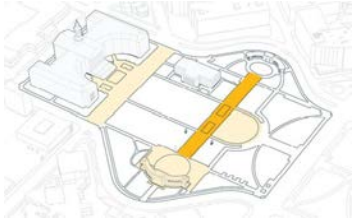

# The Central Promenade

*An Historic and Adaptable Event,  
Market and Festival Corridor and a  
Comfortable Pedestrian Space*

## OBJECTIVES

- Improve infrastructure to allow for adaptable use
- Increase day-to-day comfort
- Ensure past events can continue, include adaptability for new programs
- Preserve the historic paving pattern
- Adapt to current stormwater best management practices
- Improve infrastructure to be more durable for heavy event and vehicular use

# The Central Promenade

## Previous Workshop Summaries

### Workshop #2 Concept Options

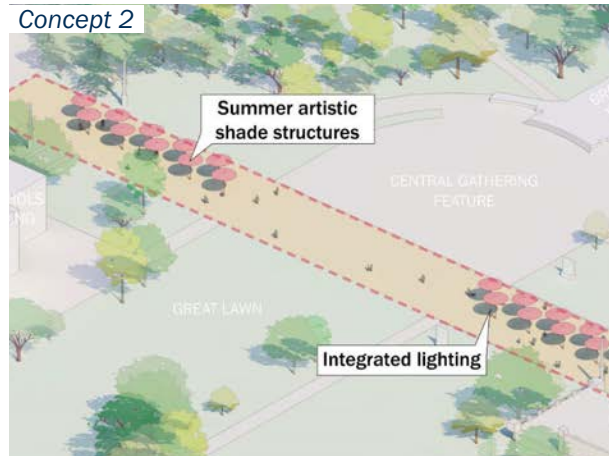
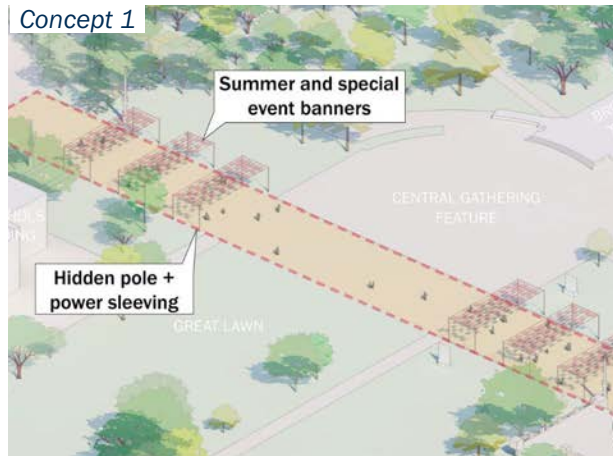

**Community Feedback from Workshop #2** expressed a desire for year round vibrancy, durability and shade. Many comments supported unique lighting features and opportunities for seating in the shade. The need for improvements to be adaptable is important to maintain accessibility for people, food trucks and events. This feedback led to the preferred concept plan images below.

### Workshop #3 Preferred Concept Plan



# The Central Promenade

## Survey Results Workshop #3

**What most excites you about the final Central Promenade vision?  
(Select all that apply)**

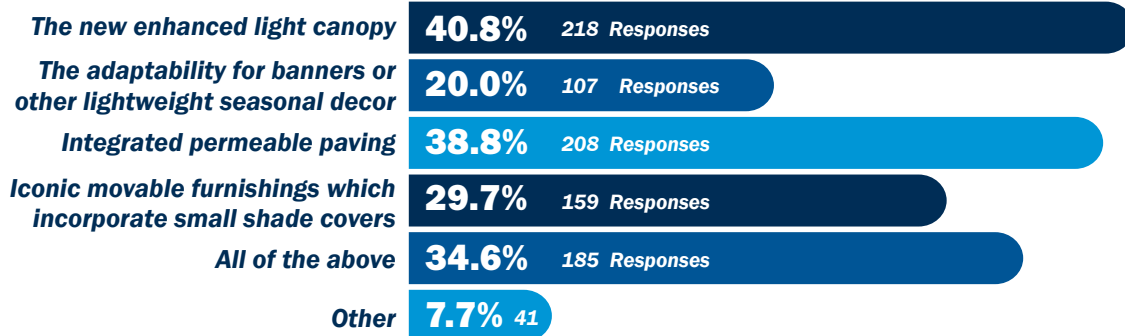

### Feedback Themes

- » Support for use of sustainable infrastructure
- » Numerous requests for shade trees and non-turf planting (Note: this is not allowed per the *Denver's Civic Center Design Guidelines, 2005*)
- » Interest in more electrical connections to cut down on generator use
- » Interest in larger shade cover options beyond the standard umbrellas
- » Interest in seating options even when there are no events happening
- » Desire for the final lighting character to complement the historic space
- » Desire for year-round lighting to increase safety



Adaptable poles for banners or lighting



New enhanced light canopy



Iconic movable furnishings

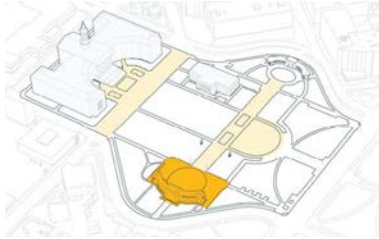

# The Greek Theater

***A Civic Park Space Adapted to  
include a Premier Outdoor  
Performance Venue***

## OBJECTIVES

- Preserve as a venue for First Amendment gatherings, rallies, and other civic activity
- Maintain the historic integrity of the space
- Program to serve as a regular activator of Civic Center Park with rallies, music, cultural performances, and community events
- Create an adaptable venue for eclectic performances and community-focused events
- Make the theater area comfortable for day-to-day and performance use
- Provide pedestrian and ADA access when events are not in-place

# The Greek Theater

## Previous Workshop Summaries

### Workshop #2 Concept Options

Concept 1

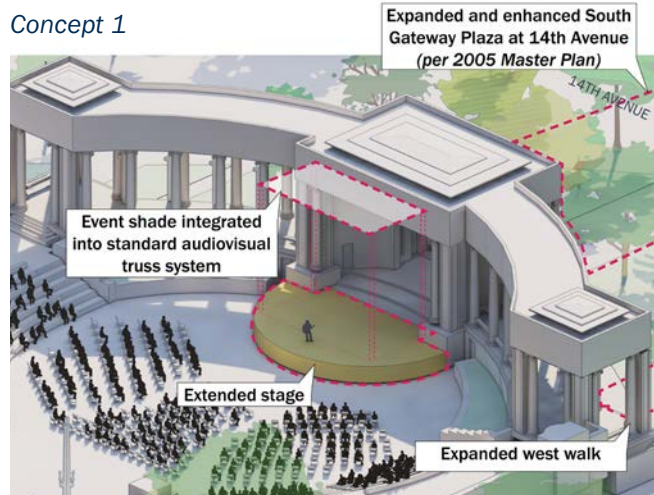

Concept 2

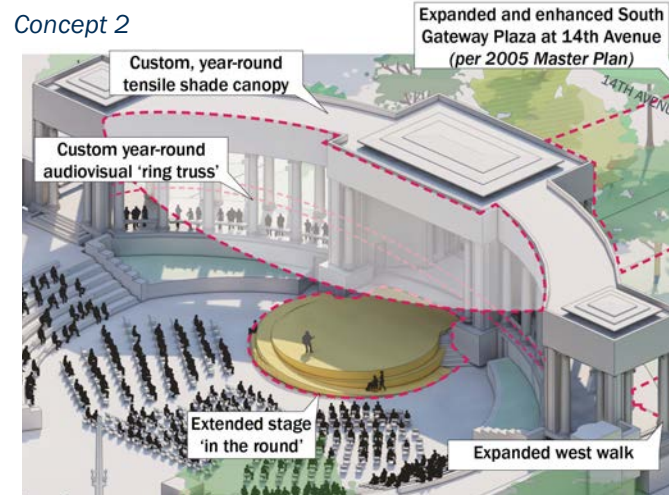

### Community Feedback from

**Workshop #2** expressed a desire to build adaptability for everyday and for community-based events, provide shade for the performer and the audience, and provide universal accessibility to and through the theater. The design should include a welcoming South Plaza and provide connection across 14th Avenue. The stage in the round was supported because of its accessibility and usability for all types of performances. The larger canopy was supported for year-round activation and an integrated truss allows for easier set up by community performance groups that would otherwise not be able to utilize the Greek Theater due to cost. This feedback led to the preferred concept plan images below.

### Workshop #3 Preferred Concept Plan

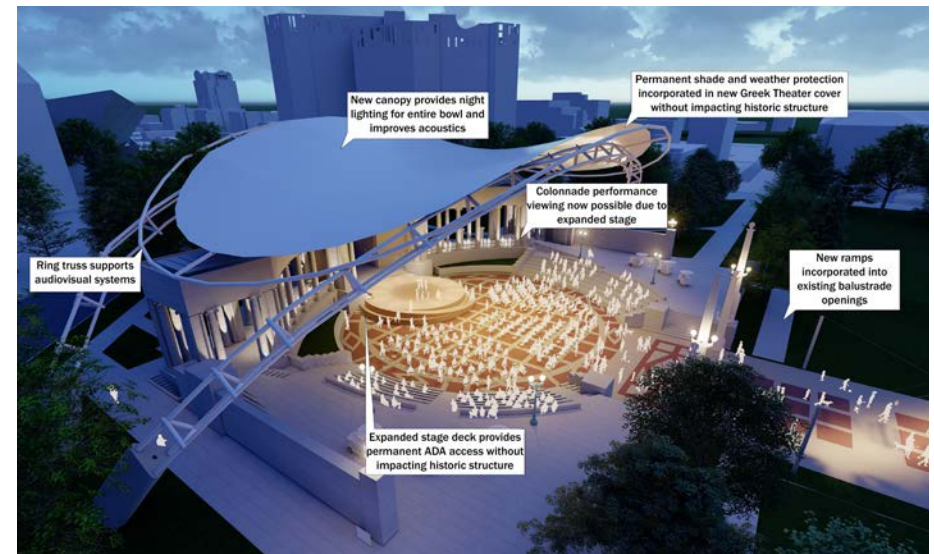

# The Greek Theater

## Survey Results Workshop #3

**What most excites you about the final Greek Theater vision?  
(Select all that apply)**

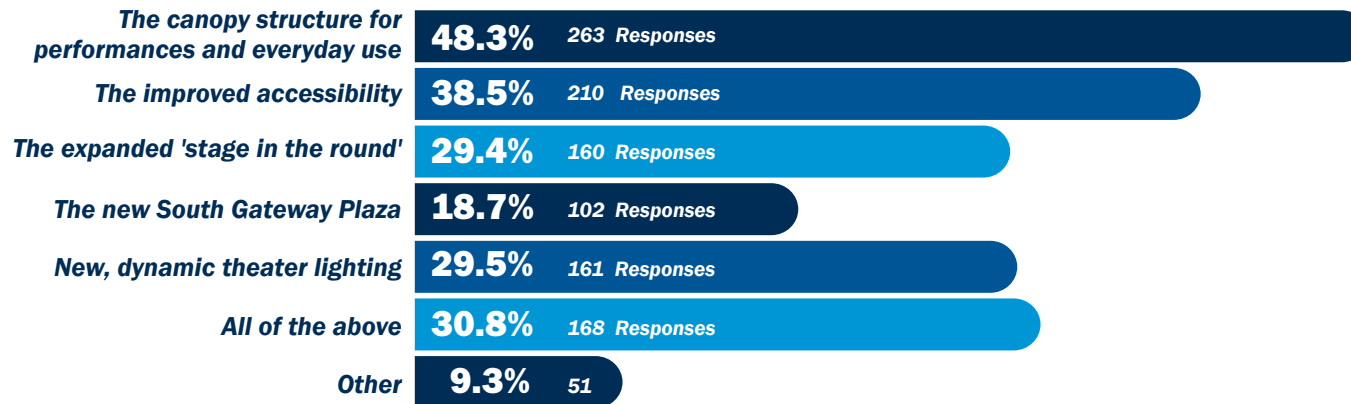

### Feedback Themes

- » Support for the contemporary canopy that creates a new energy and reinvigorates the theater for civic and cultural events
- » Support by performance groups for the large canopy to protect performers, equipment, and instruments
- » Interest in extending activation beyond scheduled performances with music or light
- » Concern about security and safety when events are not happening
- » Concern about micro-climate effects under the canopy in the winter
- » Support for an improved 14th Avenue to better connect to museums
- » Ensure that A/V systems are equipped to facilitate local and free performances
- » Support for improved accessibility and recognition of the Gang of 19 history
- » Suggested that further refinement of canopy structure should be studied to complement the existing historic structure in a contemporary way



The new South Gateway Plaza



Contemporary canopy structure and expanded 'stage in the round'



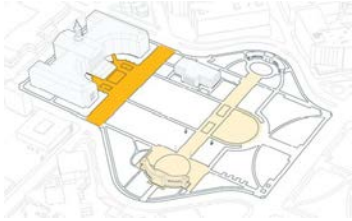

## Bannock Street

*An Event Space and Extension of the Park Balanced with Human-Scale Elements for Daily Use.*

### OBJECTIVES

- Maintain central open plaza area for events in front of the City and County Building as the primary element of the space
- Ensure secure perimeter while also providing vehicular access to the event plaza and interior park spaces via McNichols
- Balance the needs of an event market and daily comfort in the north and south areas
- Function as a bike and pedestrian transportation corridor for all but the biggest events

# Bannock Street

## Previous Workshop Summaries

### Workshop #2 Concept Options

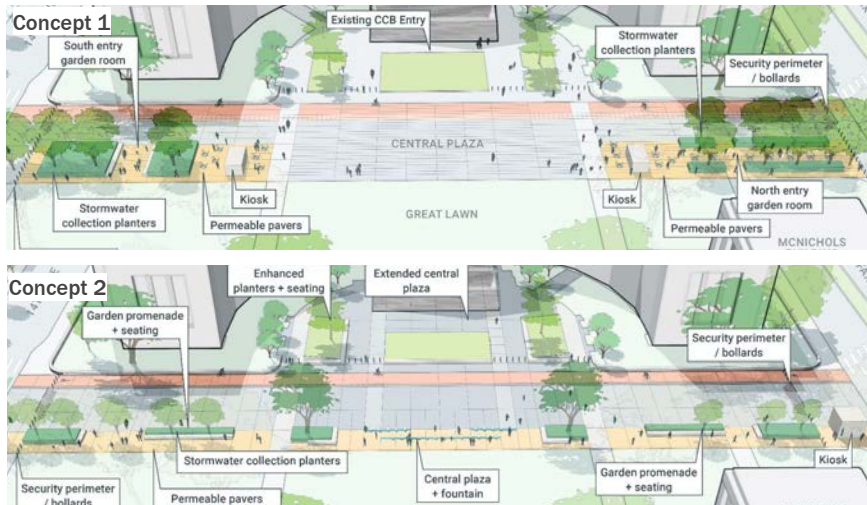

### Community Feedback from Workshop #2

expressed a desire to maintain adequate space for events and the necessary access while also making Bannock Street a place for people. Community feedback suggested increasing the tree canopy and shade, providing more seating, incorporating native plants and pollinators, utilizing stormwater collection planters, maintaining the bikeway connection to the City and County Building, and incorporating an interactive water feature. Many comments supported the larger garden rooms along with a water feature. This feedback led to the preferred concept plan image below.

### Workshop #3 Preferred Concept Plan

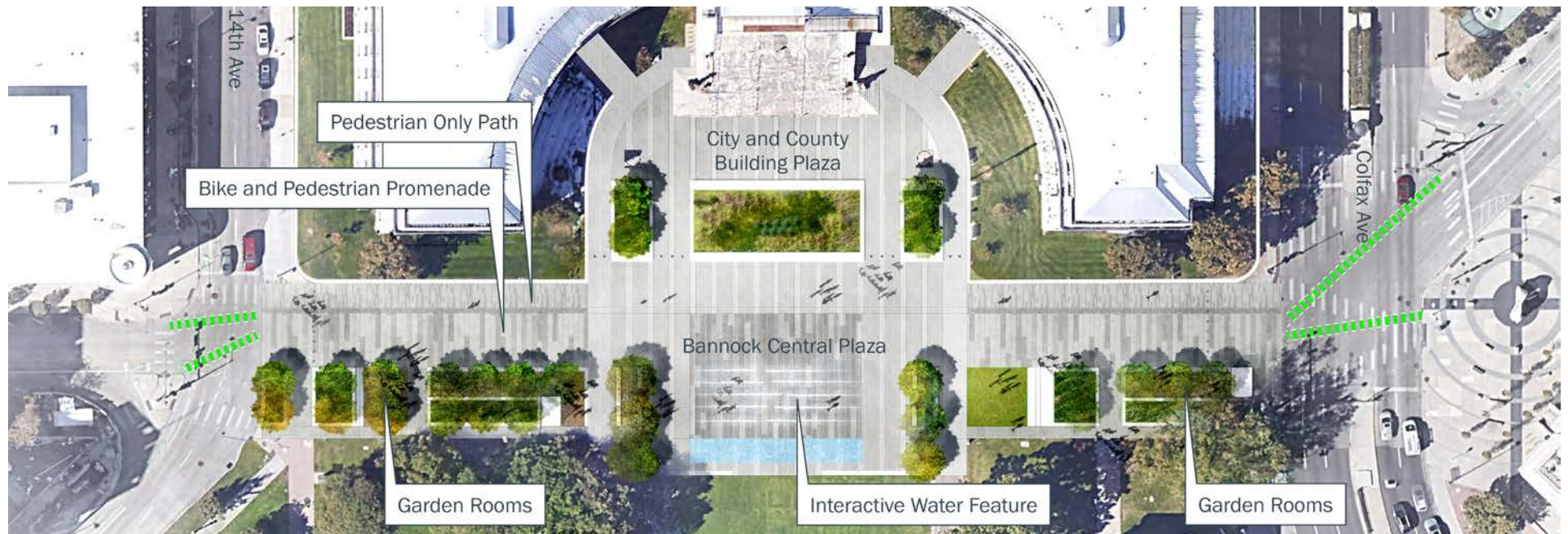

# Bannock Street

## Survey Results Workshop #3

**What most excites you about the final Bannock Street vision?  
(Select all that apply)**

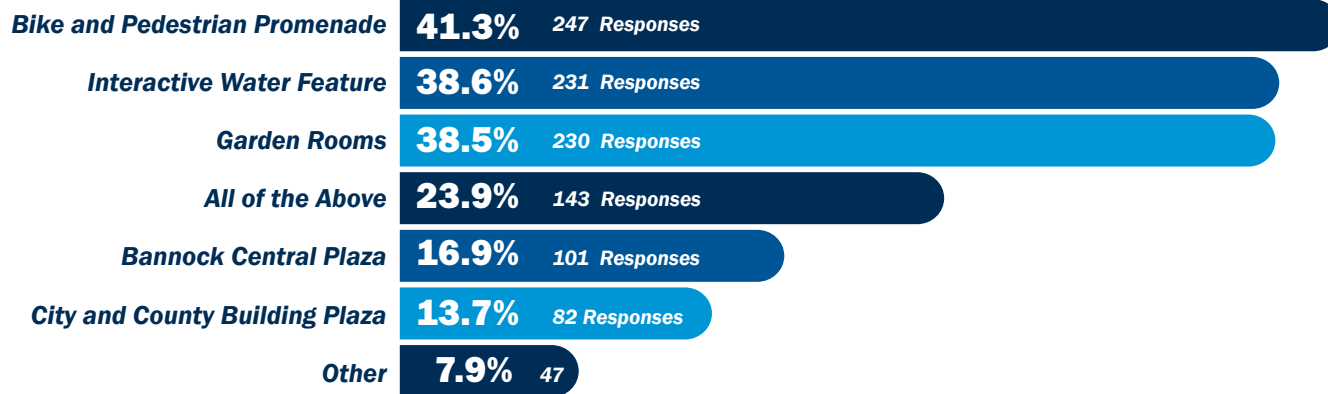

### Feedback Themes

- » Excitement for the bike and pedestrian promenade, but concerns about mixing pedestrians and bicyclists without clear delineation
- » Interest in the interactive water feature but questions around water conservation
- » Desire for shade, seating and larger garden areas
- » Interest in native plantings and pollinator gardens
- » Ensure that Bannock is an inclusive place and provides an equitable experience for all



*Bike and Pedestrian Promenade*



*Interactive Water Feature*



*Garden Rooms*

### **3. KEY TAKEAWAYS AND NEXT STEPS**

The feedback received during the Public Workshop #3 will inform the final concept plans. Concept plans form the basis for further design initiatives starting in 2022 for the Greek Theater and the Central Promenade.

# Key Takeaways

The following overarching themes emerged during the final round of the outreach process and will be carried into future design phases.

## 1. Honor and respect the historic significance and historic elements in the park.



- Complement the existing historic features to reinvigorate the space by being adaptable to new needs and a new era.

## 2. Make the park safe for all.



- Consider security, lighting and maintenance to keep the park clean, welcoming, and inviting for everyone.

## 3. Provide support for unhoused community members.



- For people experiencing homelessness continue to work with community partners to provide resources for housing, services and comfortable environments.

## 4. Provide for public health.



- Plan for space to accommodate more restrooms and handwashing stations throughout the park.

## 5. Add vegetation.



- Incorporate trees, green space, non-turf plantings, and natural shade.

## 6. Focus on sustainability.



- Consider water usage in fountains, solar opportunities, water quality, and minimizing pavement.

## 7. Keep the park accessible to everyone.



- Civic Center Park must be a civic space open to all Denverites with events that are inviting and accessible to diverse individuals and families.

## 8. Use high-quality materials and furnishings.



- Provide bike parking, seating, drinking fountains, dog stations, and lights that are high quality and can withstand heavy use and deter vandalism.

## 9. Consider a permanent food and beverage location.



## 10. Provide year-round programming and activation.



- Consider seasonality in winter and non-event times to keep the park spaces active year-round.

## 11. Incorporate wayfinding and safe and accessible connections to the surrounding areas.



## ***4. FREQUENTLY ASKED QUESTIONS (FAQS)***

## Public Workshop #3

### FAQs

**Will there still be a holiday display at City and County Building, and how will people view it during the Holidays?**

The City and County of Denver building will be lighted for the holiday season. People will be able to view the light display from Bannock Street either by bicycle or as pedestrians.

**Please expand on how you see the proposed Greek Theater shade structure celebrating the historic significance of the Civic Center landmark.**

The proposed shade structure is first and foremost designed to facilitate reactivation of the Greek Theater for the civic and cultural events for which it was originally designed and to restore its historic use as premier outdoor performance venue. The new canopy structure will house audio/visual systems and protect performers from inclement weather as well as providing shade for the public while limiting alterations of the historic theater.

The conceptual design vision preserves views of the Greek Theater from the Central Promenade. Future design refinements will engage a design team with expertise in tensile structures to further refine the design of both the structure and canopy to carefully complement the historic design vocabulary in a contemporary way, responding to guidance from the Landmark Preservation Commission.

## Public Workshop #3

### FAQs

Will the Allen True murals be preserved? If so, how will access to the murals be maintained in the renovation of the Greek Theater?

Yes, preservation of the historic murals is the first priority in the treatment of the historic alcoves. The concept design explores a strategy to enclose the alcoves by converting them to a usable back-of-house space for the theater to ensure the murals do not see further damage. These enclosures would not impact the historic structure.

Will the focus on more maintenance at Civic Center Park take away from maintenance at other Denver Parks? Can you give me assurance that resources throughout Denver will be increased rather than decreased to keep Civic Center up to snuff?

Denver Parks and Recreation received approval for additional staff in the 2022 budget to increase park staff and rangers in the downtown area. There will not be a decrease in services in other areas of the City.

*If you have additional questions that were not answered in the FAQ document or if you need a Spanish language copy, please email:*

**[parksandrecreation@denvergov.org](mailto:parksandrecreation@denvergov.org)**

*Stay up to date on the Civic Center Next 100 project by visiting*

**[www.denvergov.org/theoutdoordowntown](http://www.denvergov.org/theoutdoordowntown)**



***THANK YOU***