

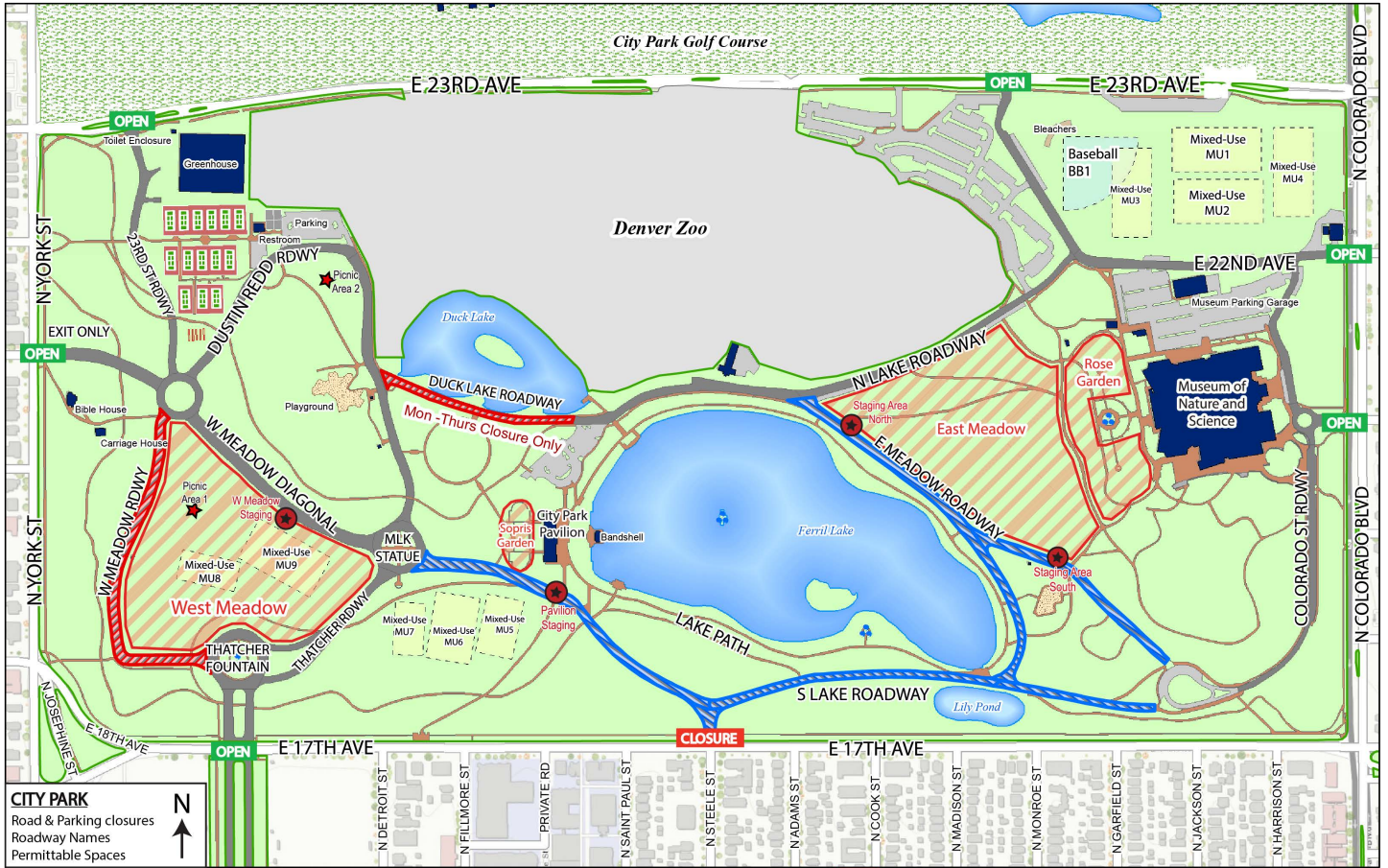

Have an activity at City Park Pavilion? Let us help you get there!

Park Space	Directions
Pavilion	Parking is available on a first come first serve basis. Easiest access is through the east side using the E 23rd Ave. or E 22nd Ave. entrances. You may also park in the surrounding residential neighborhoods and walk in



1 inch = 350 feet at 11x17
100
Map Scale in Feet

- Closed to Vehicles
- Pre-COVID Closed to Vehicles