

# Skyline Park Improvements

Public Workshop #2  
Engagement Summary & Follow-Up Q&A

Spring 2021

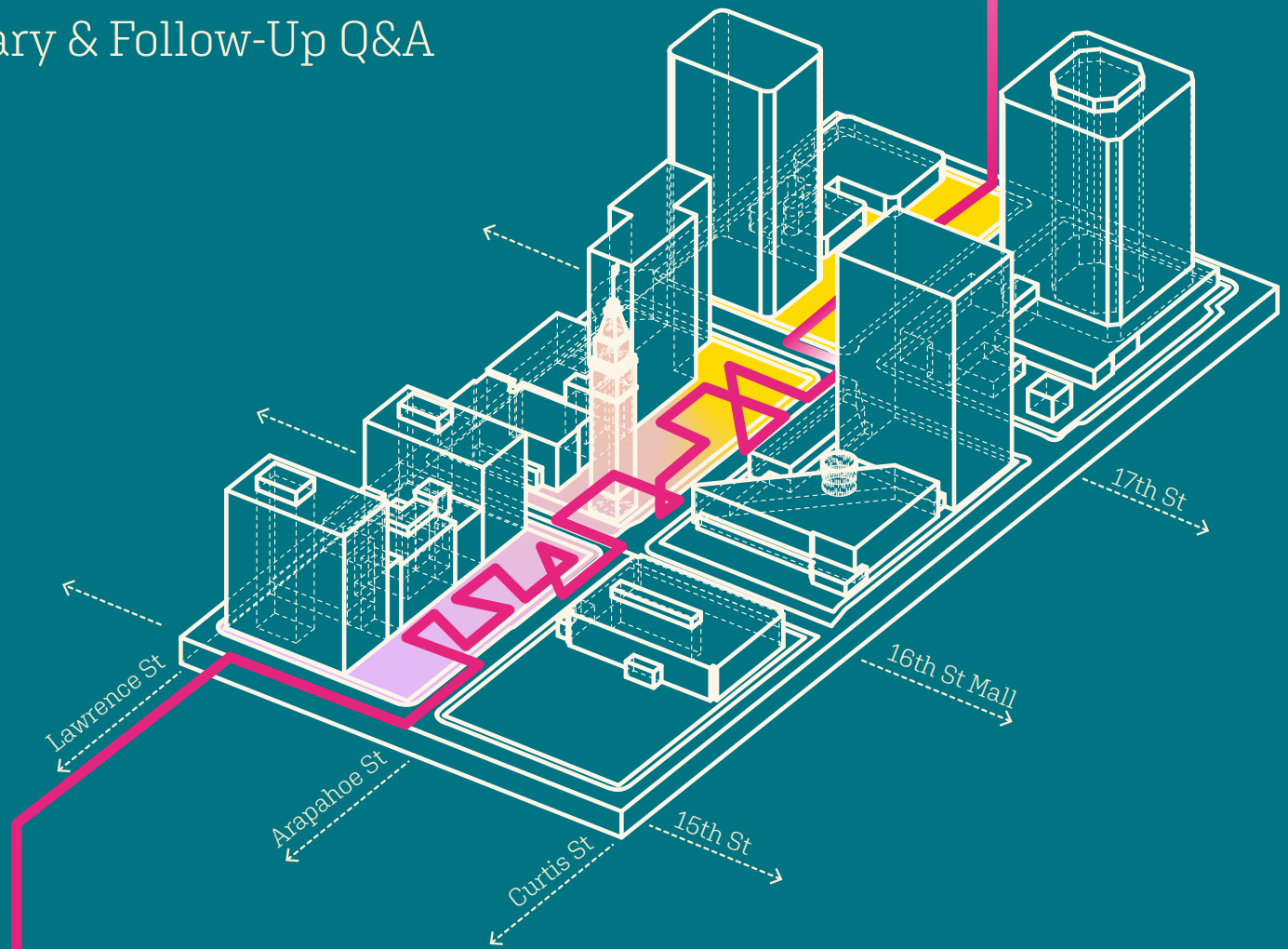



**Skyline Park**

Arapahoe St

16th St Mall

# **Contents**

- 1 Engagement Process**
- 2 Basis of Design & Concept Options Feedback Summary**
- 3 Design Process Next Steps**
- 4 Workshop #2 Follow-Up Q&A**

# 1. Engagement Process

## Engagement Process Components

---

### Stakeholder Committees

Stakeholder Advisory Committee (SAC) | 3/3/2021 | **62 participants**

Technical Advisory Committee (TAC) | 3/2/2021 | **23 participants**

### D&F Tower Projection & Yard Signs

In conjunction with Downtown Theater District and the Downtown Denver Partnership, Denver Parks & Recreation was able to advertise the workshop by projecting onto the D&F Tower. Yard signs with QR codes were also posted in Skyline Park.

### Focus Group

Joint Focus Group\* | 3/3/2021 | **59 participants**

\* For Workshop #2, we combined the PEOPLE, PLACE and LIFESTYLE Focus Groups from Workshop #1 into one joint focus group to discuss and provide feedback on the concept options.

### Virtual Public Workshop #2

Public Workshop | 3/4/2021 | **110 participants**

Makeup Break-out Group\*\* | 3/16/2021 | **32 participants**

\*\* Due to technical difficulties, some people were not able to join the “break-out” small group discussions following the March 4th webinar. As a result, we hosted an additional “break-out” virtual discussion on March 16th. The content and format was identical to the one held on March 4th.

### Online & Paper Survey

3/4/2021 - 4/5/2021 | **761 participants**

# Skyline Park

People. Place. Lifestyle.

## Online Public Workshop #2

Thursday,  
March 4, 2021  
5:30-7:00pm

Join us on Zoom:  
[rebrand.ly/skyline](https://rebrand.ly/skyline)

Learn more about  
the project:  
[www.denvergov.org/  
theoutdoordowntown](http://www.denvergov.org/theoutdoordowntown)

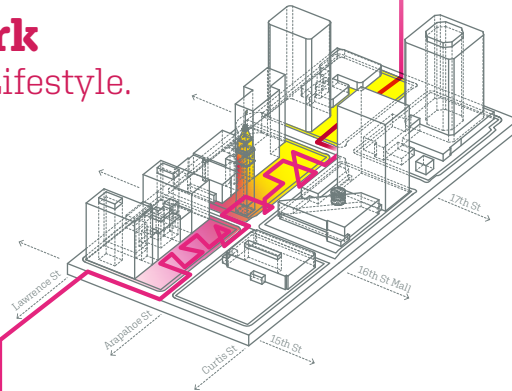

**Please join us for the second public workshop for the reimagining of Skyline Park! Come to review concept options and provide feedback for the future design of your park.**

**The Skyline Park Improvements Project will create a new concept design for all three blocks of the park and develop a design for construction of Phase 1, which is located within Block 2 (adjacent to the D&F Tower). This project is funded by the Elevate Denver Bond Program.**

Para pedir interpretación al español, por favor mande un correo electrónico a [parksandrecreation@denvergov.org](mailto:parksandrecreation@denvergov.org). A sign language interpreter or CART will be provided upon request. Three business days notice is requested. Contact [signlanguageservices@denvergov.org](mailto:signlanguageservices@denvergov.org). For any other accommodation requests/concerns contact [disabilityaccess@denvergov.org](mailto:disabilityaccess@denvergov.org).



# 1047+ participants

provided feedback during this outreach effort

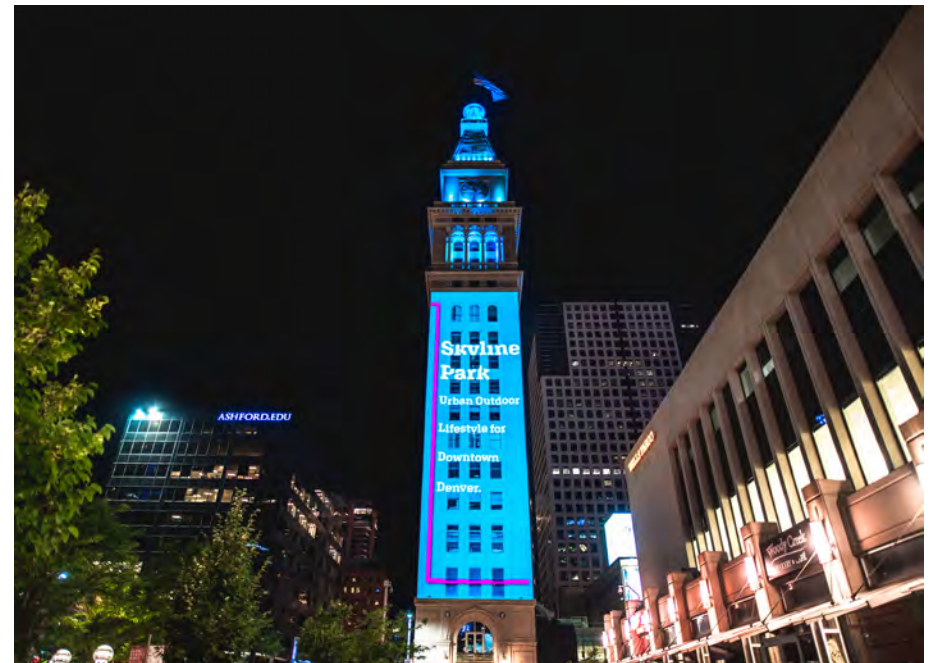

## 2. Basis of Design & Concept Options Feedback Summary

### Basis of Design

**Unified:** The next Skyline Park should be unified by a tapestry of lawns and plantings, plazas and pathways.



**Connected:** The next Skyline Park should be fully connected with surrounding streetscapes and ground floor uses.



**Spectrum:** The next Skyline Park should offer a spectrum of experiences to attract a diverse community.



### Feedback on Basis of Design

#### Feedback Themes

- Desire for More Trees & Greenery
- Desire for More Shade
- Support for a Cohesive, Unified Park
- Support for Activation & Unique Experiences
- Support for Expanding the Park into Arapahoe Street

*“Yes! Love the design thinking and programmatic goals. Only thing I’d say is MORE TREES!!”*

*“Outdoor shade is wonderful for people to gather in medium sized groups as relief from the sun for outdoor gatherings.”*

*“Key in determining the uses (active/passive) and interactive components for the park is consistency in design and use approach for the entire three blocks, which will work towards unifying the park as one, instead of three separate blocks.”*

*“Seems like a logical approach is for each [block] to have their character; How can each block be known for something?”*

*“Activation and programming is super important for these blocks.”*

*“The best parks allow people to both linger and pass through with ease.”*

*“Love the idea of expanding the park into Arapahoe Street and across the street!!”*

# Skyline Park Concept Options

Community feedback from Workshop #1 suggested the importance of providing cultural, social, and recreational programming that is both connected and sustainable. Feedback also reinforced that the park design should balance flexibility and specificity, while serving different audiences at different times of day, week, and year. The design team then worked to create two initial concept options for Skyline Park, built directly upon this community input.



**Concept Option A:** Option A features a more “formal” organization of space, with a focus on providing a range of spaces that clearly support different types of activation and programming.

**Concept Option B:** Option B focuses on providing more flexible park spaces, centering on nature, recreation, and passive uses.

## Concept Option A

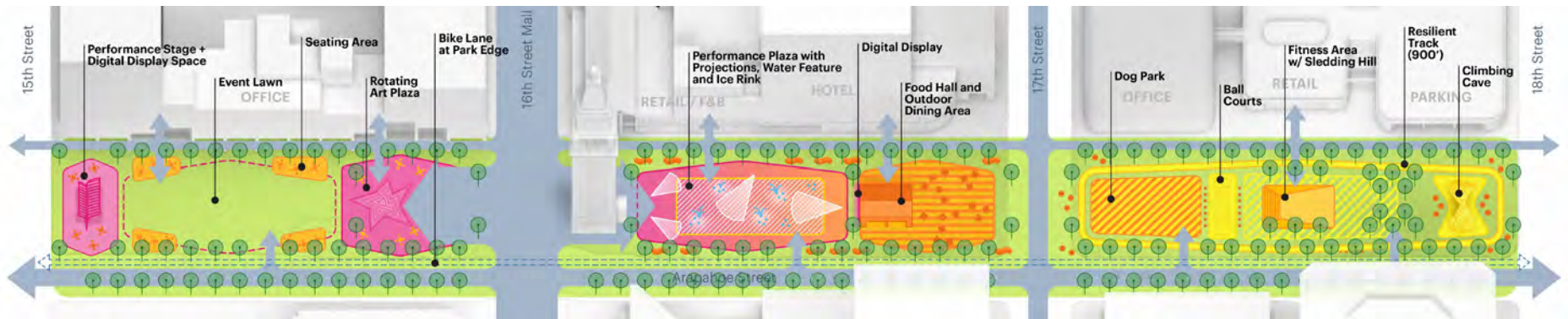

## Concept Option B

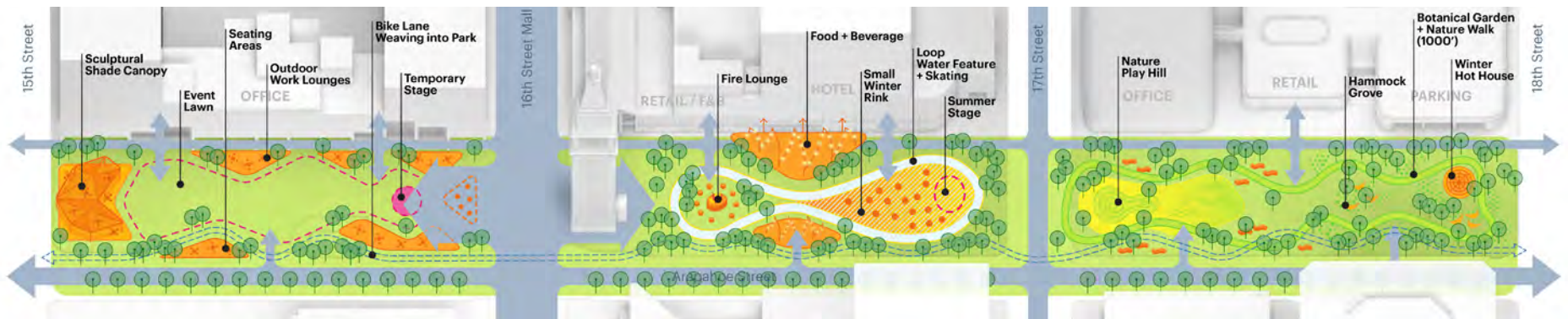

## Feedback on Skyline Park Concept Options

### Block 1

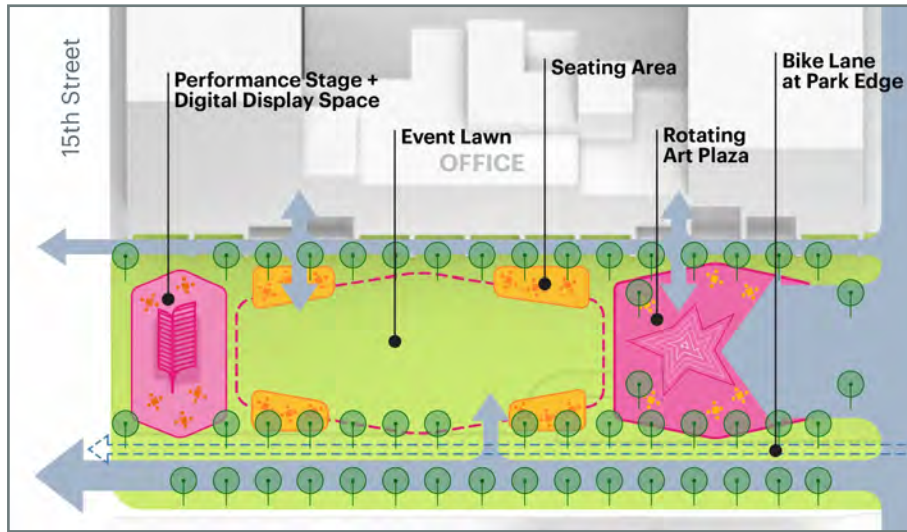

Block 1 Concept Option A

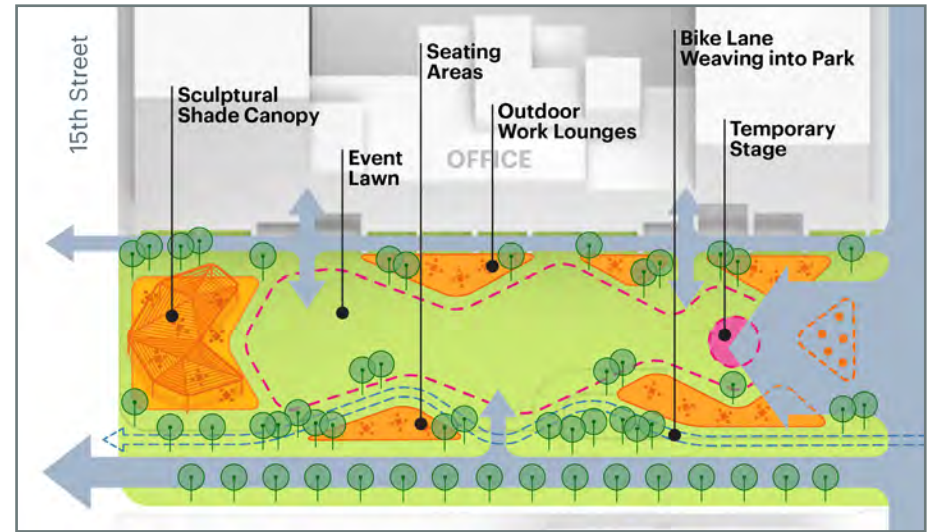

Block 1 Concept Option B

### Feedback Themes

- Importance of Programming & Activation
- Support for Public Art and Cultural/Arts Programming
- Spaces for Gathering & Shaded Seating
- Concerns about Unhoused Community & Loitering



***“The more outdoor cultural experiences, the better.”***

***“Downtown would benefit from an urban flex park to keep it activated more often.”***

***“I think art is a very important part of Denver and Skyline Park, so rotating installations would be perfect.”***

***“I like the idea of arts and events space, but it can be done with the greenery and shade canopies of option B.”***

***“I think shade is an essential part of this. Denver is so sunny and hot in the summer that shade becomes a really valuable commodity.”***

***“With all the office buildings nearby, it would be nice to have outdoor work lounges and shade, but also art and entertainment.”***

***“I am concerned about how secure the park will be and the impact of transient/unhoused communities.”***

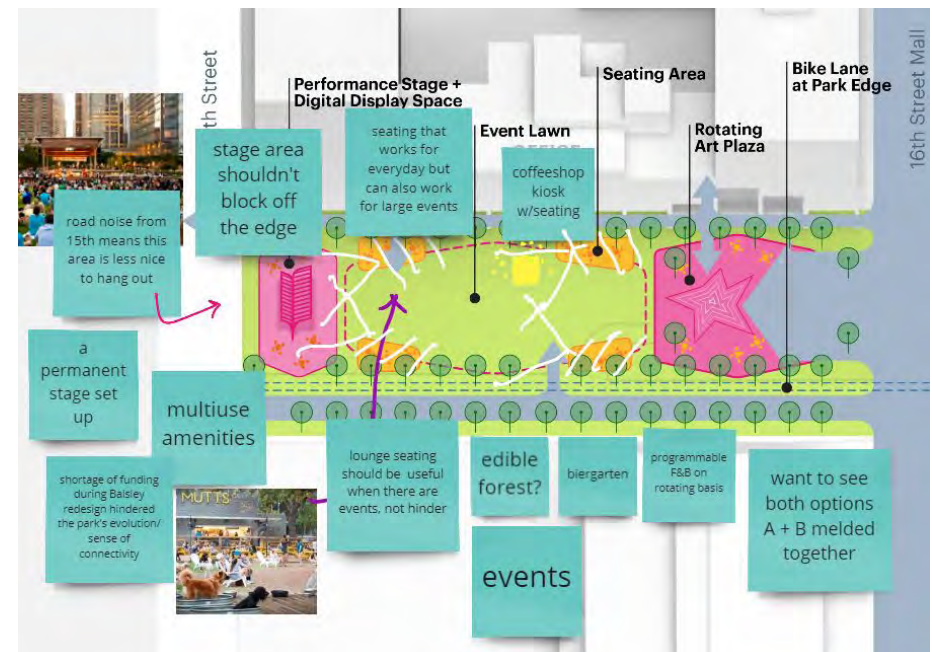
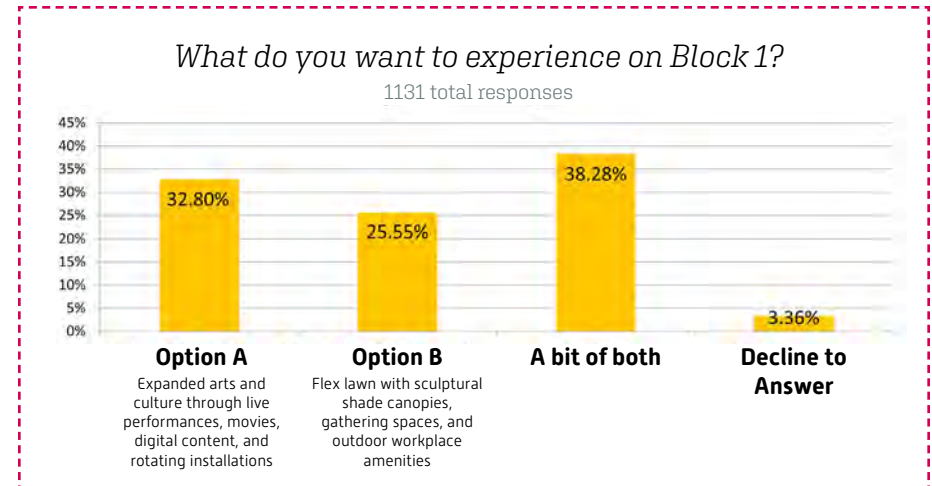

Snapshot of Online Public Workshop #2 Breakout Session, interactive discussion about Block 1

## Feedback on Skyline Park Concept Options (cont.)

### Block 2

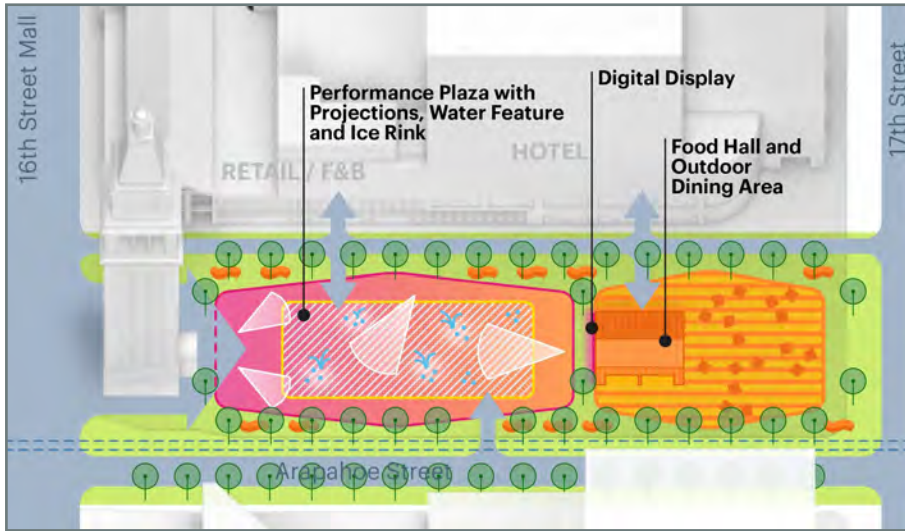

Block 2 Concept Option A

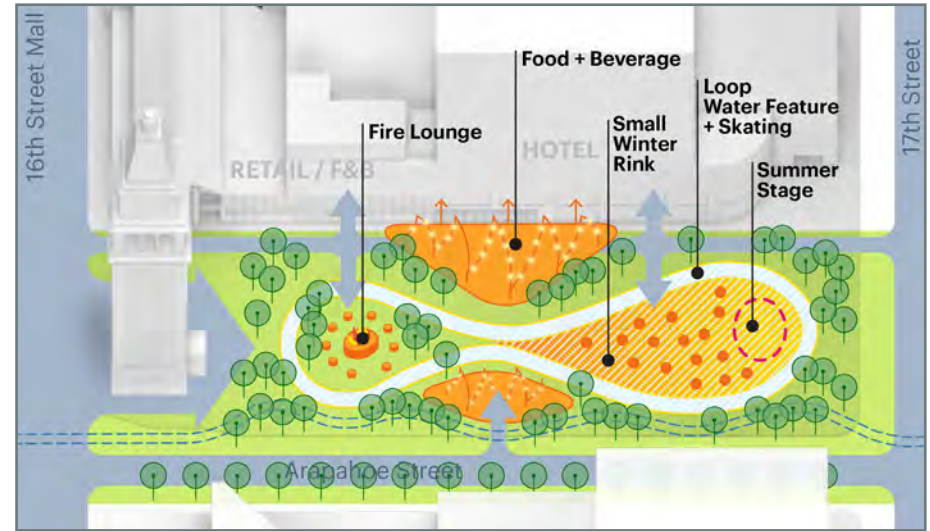

Block 2 Concept Option B

### Feedback Themes

- Support for Food & Beverage (F&B)
- Interest in “Loop” Design of Water and Skate Feature
- Important Role of the D&F Tower
- Concerns over Potential Demolition of Halprin Fountain

*“Food hall paired with a fun water feature starts to create the “there-there” along the 16th St Mall. Getting exciting!”*

*“Keep food simple.”*

*“The food can surround a large skating area/water park so those enjoying a meal can watch the area.”*

*“I really like the idea of a skating loop that winds around trees lit up with beautiful lights.”*

*“The water play is great for both kids and adults.”*

*“The D&F tower is a wonderful landmark visible down the Mall and in the Park. I would love to see a design axis created that puts the tower as the signature centerpiece in the park.”*

*“I worry that this implementation will entirely remove the fountain sculpture. Beyond destroying the parkour community, it would be heartbreaking to see a Halprin fountain get demolished.”*

*What do you want to experience on Block 2 in terms of a water feature and skating?*

1082 total responses

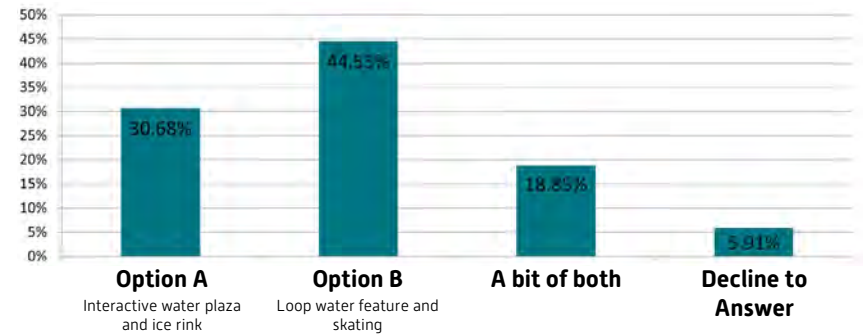

*What do you want to experience on Block 2 in terms of food and beverage?*

1093 total responses

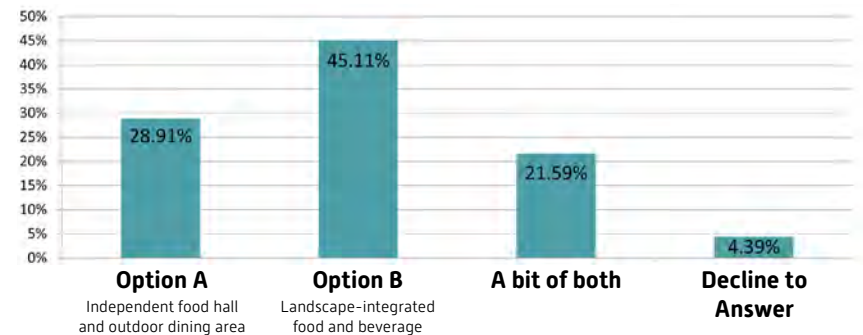

## Feedback on Skyline Park Concept Options (cont.)

### Block 3

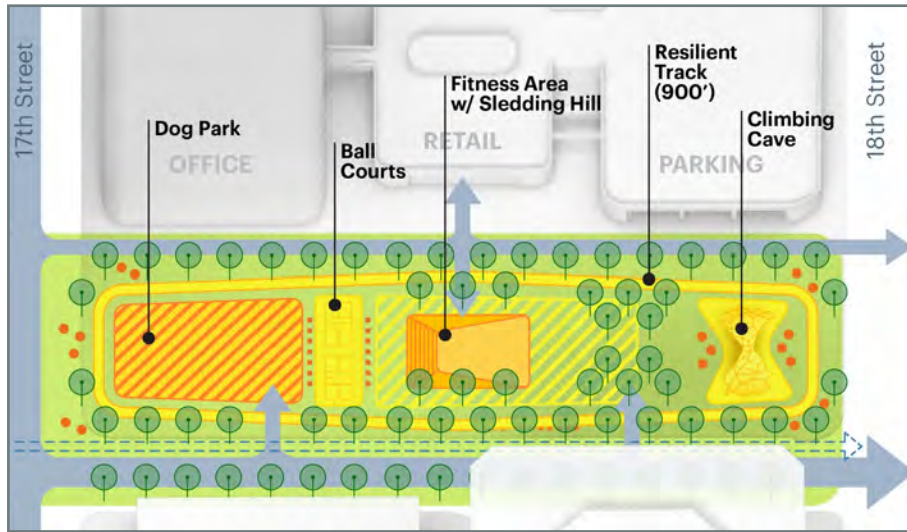

Block 3 Concept Option A

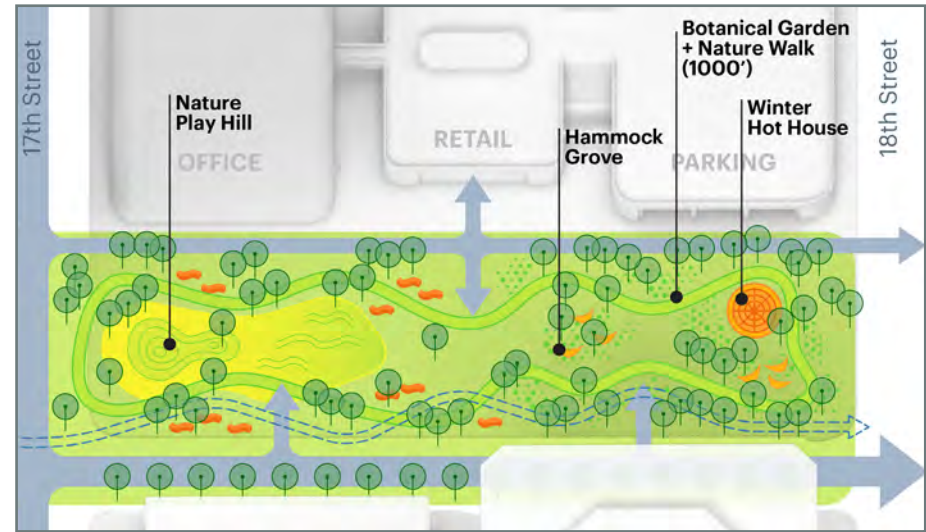

Block 3 Concept Option B

### Feedback Themes

- Need to have a Draw on Block 3 to pull people from the Mall
- Family-Friendly Spaces for Play
- Support for Fitness & Parkour
- Support for Dog Park
- Desire for more Active Uses
- Desire for a Refuge from the City

*“Inviting, multi-generational playscapes. Playgrounds large enough for adults to participate. Bouldering walls, nature-themed fitness park. Trees to climb. Encouraging people of all abilities to enter and actively engage (or comfortably supervise their grandkids.)”*

*“[I like] having Block 3 more natural, a more of a refuge for the neighboring residents.”*

*“I’d love to see a parkour-themed park/play area so that it encourages play, exercise, and natural movement.”*

*“A fitness zone would bring both residents and workers to Block 3 on a daily or weekly basis, which would really increase the sense of community ownership of the park, which is lacking now.”*

*“The dog park is [well] used... Give dog owners something else to do to bring the experience together with the whole park.”*

*“Need to put more emphasis on Block 3 to pull more people to it.”*

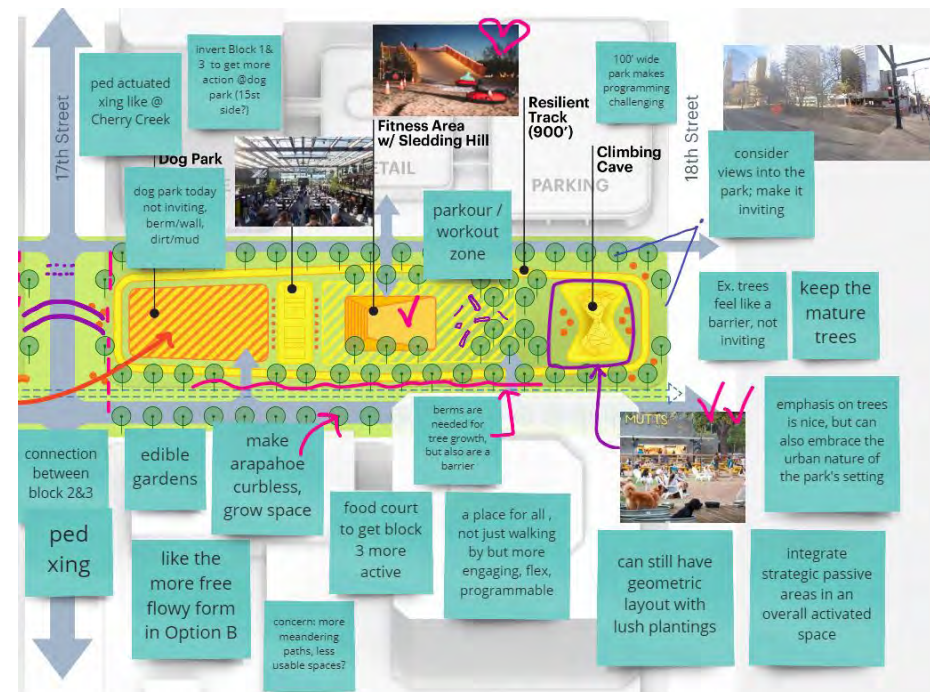
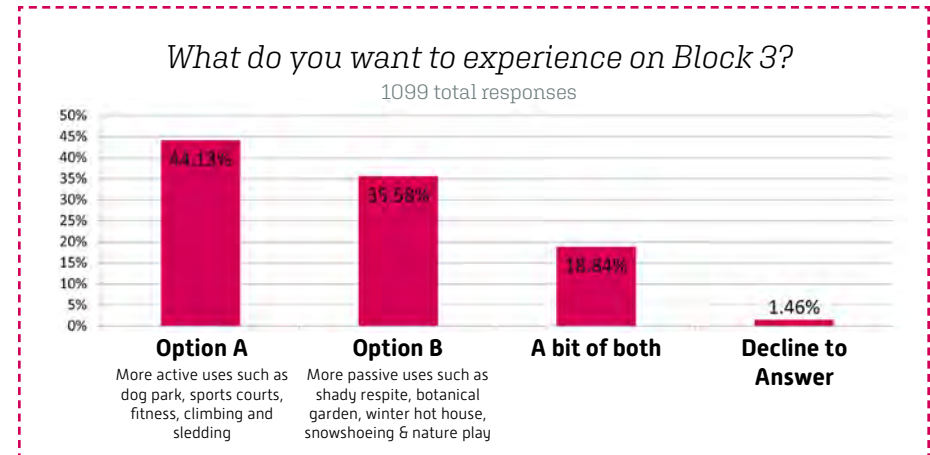

Snapshot of Online Public Workshop #2 Breakout Session, interactive discussion about Block 3

# 3. Design Process Next Steps

## Summary of Key Takeaways from Public Workshop #2

The community engagement process surrounding Workshop #2 uncovered a number of key themes and takeaways related to the Basis of Design and Initial Concept Options, including:

- Desire for More Trees, Greenery, and Shade
- Support for a Cohesive, Unified Skyline Park
- Support for Activation & Unique Experiences
- Support for Expanding the Park into Arapahoe Street
- Importance of Programming & Activation in all Blocks
- Support for Arts/Cultural Programming in Block 1
- Support for Landscape-Integrated F&B in Block 2
- Interest in "Loop" Design of Water and Skate Feature in Block 2
- Concerns over Loitering
- Concerns over Potential Demolition of Halprin Fountain
- Need to have a Draw on Block 3 to pull people from the Mall
- Support for Active Uses in Block 3 (such as fitness, parkour, dog park, family-friendly play spaces)

## Next Steps

Denver Parks & Recreation and the design team will be interpreting the feedback we received on both concept options, including from participants who chose "a bit of both," and will then use this input to synthesize a draft final concept plan for all three blocks of Skyline Park, which will be shared with the public during Workshop #3 this summer.

## More Information

To stay up to date and for more project information please visit: [www.denvergov.org/theoutdoordowntown](http://www.denvergov.org/theoutdoordowntown)





# Workshop #2 Follow-Up

# Q&A

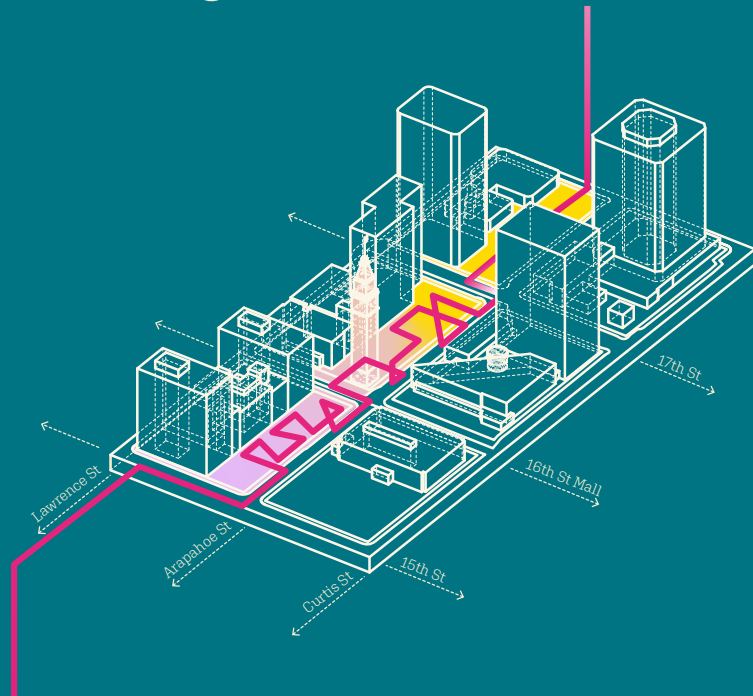

If you have additional questions that were not answered in this FAQ document, please email:  
**[ParksAndRecreation@denvergov.org](mailto:ParksAndRecreation@denvergov.org)**

## GENERAL

### **1. How will you fund all of these concept ideas for a \$2.5 million dollar budget?**

The Elevate Denver Bond, which was passed by Denver voters in 2017, will contribute \$2.5 million dollars towards the concept design for all three blocks and the final design and construction of Phase 1 of Skyline Park. Additional funds will be necessary to implement the full redesign for all three blocks of Skyline Park. It is anticipated that a combination of public and private funding will be necessary to complete the full implementation of the new design.

### **2. How will you prevent illicit or otherwise disruptive activities in the future design of the park?**

Safety and security in the parks is of the utmost importance to Denver Parks & Recreation. Illegal activities are not permitted within Skyline Park or any of Denver's park. The Skyline Park Improvements project will address issues of safety and security through design where possible.

Skyline Park is an integral part of downtown's parks and public space network and must be a welcoming destination for all. It should equitably bring diverse people together through a mix of unique events as well as everyday outdoor experiences. The goal is for Skyline Park to be a destination for neighborhood residents, downtown workers, as well as visitors to Denver. The park's design will include active and passive recreation, programs and events, and amenities that make the park safer and more accessible through better circulation, clear sight lines, enhanced landscape elements, furnishings, public art, lighting, signage and wayfinding. A local maintenance district was also formed by the surrounding property owners to enhance services and provide a clean, safe, and memorable park experience.

If you have concerns about safety while visiting a Denver Park, we recommend calling 311 and asking to connect with a Denver Park Ranger.

### **3. How has the project team engaged with adjacent property owners in the park redesign process?**

Denver Parks & Recreation has worked closely with the Downtown Denver Partnership to engage the property owners that surround Skyline Park. Property owners and nearby residents have provided input into the early concepts through public meetings and surveys, and will continue to have opportunities to provide ideas as the design progresses.



# Workshop #2 | Follow-Up Q&A (cont.)

## DESIGN

### **4. What support do you hope to get to expand the park into Arapahoe Street? Who would fund this?**

Denver Parks & Recreation is working with our partner agency, Denver's Department of Transportation and Infrastructure (DOTI), to evaluate options for expanding Skyline Park into Arapahoe Street as well integrating the existing on-street bike lane into the park. As with all three blocks of Skyline Park, funding beyond the \$2.5 million from the Elevate Denver Bond is still being secured for implementation. It is anticipated that a combination of private and public funding will be necessary to implement the full park redesign.

### **5. Has the design team explored removing curbs from Arapahoe Street adjacent to Skyline Park for it to feel like it's part of the park?**

A variety of streets sections are being explored for Arapahoe Street in coordination with Denver's Department of Transportation and Infrastructure (DOTI). The design team is also studying narrowing the roadway width of Arapahoe Street, improving pedestrian crossings at intersections, and integrating the park and streetscape design by designing consistent planting and hardscape materials.

### **6. How do you plan to connect Blocks 2 and 3 of Skyline Park across 17th Street?**

A mid-block crossing is being explored for the crossing of 17th Street at Skyline Park in coordination with DOTI. This crossing would allow pedestrians to move along the park sidewalk at the base of the adjacent buildings in Skyline Park and cross 17th Street safely. While the travel lanes cannot be reduced on 17th Street, the team is also studying applying park materials to the sidewalks between Block 2 and 3 to improve the sense of continuity between the two sides of 17th Street.

### **7. Will the new Skyline Park design preserve the existing fountains in Block 2 and 3?**

Denver Parks & Recreation's (DPR) goal for Skyline Park is to create a cohesive design that will result in a safe, clean, and welcoming space for all. Skyline Park has seen several modifications to its design over the years, which has resulted in an unsuccessful patchwork of elements. DPR intends to align the future park design with the evolving needs of the communities that Skyline Park serves. Working with the public, our design team will evaluate all existing park elements to see how they can support the project's vision and goals.

### **8. How is sustainability and the "every drop" concept being taken into account with the water features?**

Any water features being proposed for Skyline Park will balance aesthetic and experiential benefits with water conservation to make the most of this valuable resource. The design team has engaged Fluidity, a consultant noted for their sustainable approach to creating interactive water features that use water and electricity efficiently.

### **9. If one of the goals is to create a "shady respite," how realistic, cost effective, and water conscious will the designs be?**

With Denver's climate growing hotter and the urban heat island effect as a major concern for Downtown Denver, increasing the urban forest canopy is a priority for the City of Denver. Denver Parks & Recreation, in collaboration with the Downtown Denver Partnership, is a partner in the Downtown Urban Forest Initiative to increase tree canopy downtown. Shade trees will require irrigation but will also provide multiple benefits, including shade, habitat, microclimate cooling, stormwater management, and improved wellness for urban residents and visitors.

# Workshop #2 | Follow-Up Q&A (cont.)

## **10. The current wand lights in the park do not provide safety lighting. Will the design consider an improved lighting plan?**

Updated lighting will be incorporated with future park improvements. Adequate light coverage will be an important consideration in the lighting design improvements.

## **11. What is the plan for public restrooms in this park design?**

Currently a public restroom exists within Block 1 of Skyline Park. This restroom will remain open and accessible for the foreseeable future. The future design of the Skyline Park will include accessible year-round restrooms.

## **12. Will a new interactive water feature require an adjacent changing area/ restroom?**

Although a changing room will not be required, the water feature design will comply with all state health department requirements for both design and maintenance of any interactive water feature(s) built in the park.

## **13. Block 3 would benefit from more eyes on the park and more activation. Has the design team considered adding more amenities and active uses here?**

Public Workshop #2 highlighted a variety of programming options for Block 3 to attract greater activation including fitness areas, sports courts, public art, dog park, and play area.

## **14. The existing lawn on Block 1 of Skyline Park frequently requires new sodding. Is the design team considering artificial turf on this block?**

The design team will evaluate a variety of natural and artificial options for any proposed lawn areas in coordination with Denver Parks & Recreation's Downtown Operations and Maintenance team.

## **ADJACENT PROJECTS**

### **15. How will you be integrating this design with the ongoing Civic Center Next 100 project?**

Denver Parks & Recreation is currently leading two significant design efforts within Downtown Denver, the Skyline Park Improvements and Civic Center Next 100 projects. These projects are being closely coordinated to provide complementary programming. While these projects are less than a mile from one another, the adopted goals and identified needs of each park project are unique. As the designs for both parks evolve, Denver Parks & Recreation will continue to refine them based on site specific context and project goals.

### **16. Have these design options been coordinated with the current refurbishing plans for the 16th Street Mall?**

The Skyline Park project and 16th Street Mall Improvements project are being closely coordinated. While the Mall project has already developed a Basis of Design, the two teams are working together to coordinate the design details as each project progresses.

### **17. Is there an opportunity to integrate Skyline Park into the 5280 Trail?**

Denver Parks & Recreation is working closely with the Downtown Denver Partnership and Denver Department of Transportation and Infrastructure to coordinate opportunities to integrate the two projects. The Arapahoe Street bike lane, which will be incorporated into the Skyline Park project, will provide as an important north south connector to the 5280 Trail. The Skyline Park project team has also advocated for this route to become an official "spur" in the 5280 trail project.