



Washington Park Master Plan

February 10th, 2011 PRAB Presentation



Why a Master Plan?



Purpose of the Plan

- Reviews Park Safety, Access, Maintenance, and Use Issues
- Provides a Means for Community Input
- Ensures protection of historic values while setting a vision for future park improvements
- Describes and Prioritizes Park Improvement Projects



Washington Park Master Plan

Final DRAFT Report
10/27/10



ASSOCIATED
PLANNERS &
LANDSCAPE
ARCHITECTS

Planning Context

- **Historic Significance**
- **Park User Input**
- **External Stakeholder Input**
- **Internal Stakeholder Input**
- **Professional Park Planner & Consultant Input**
- **City & Department Policies**
- **Safety & Operations Review**

Preservation Plan

- **Basis for Master Plan**
- **General Guidance**
- **Contributing Areas**

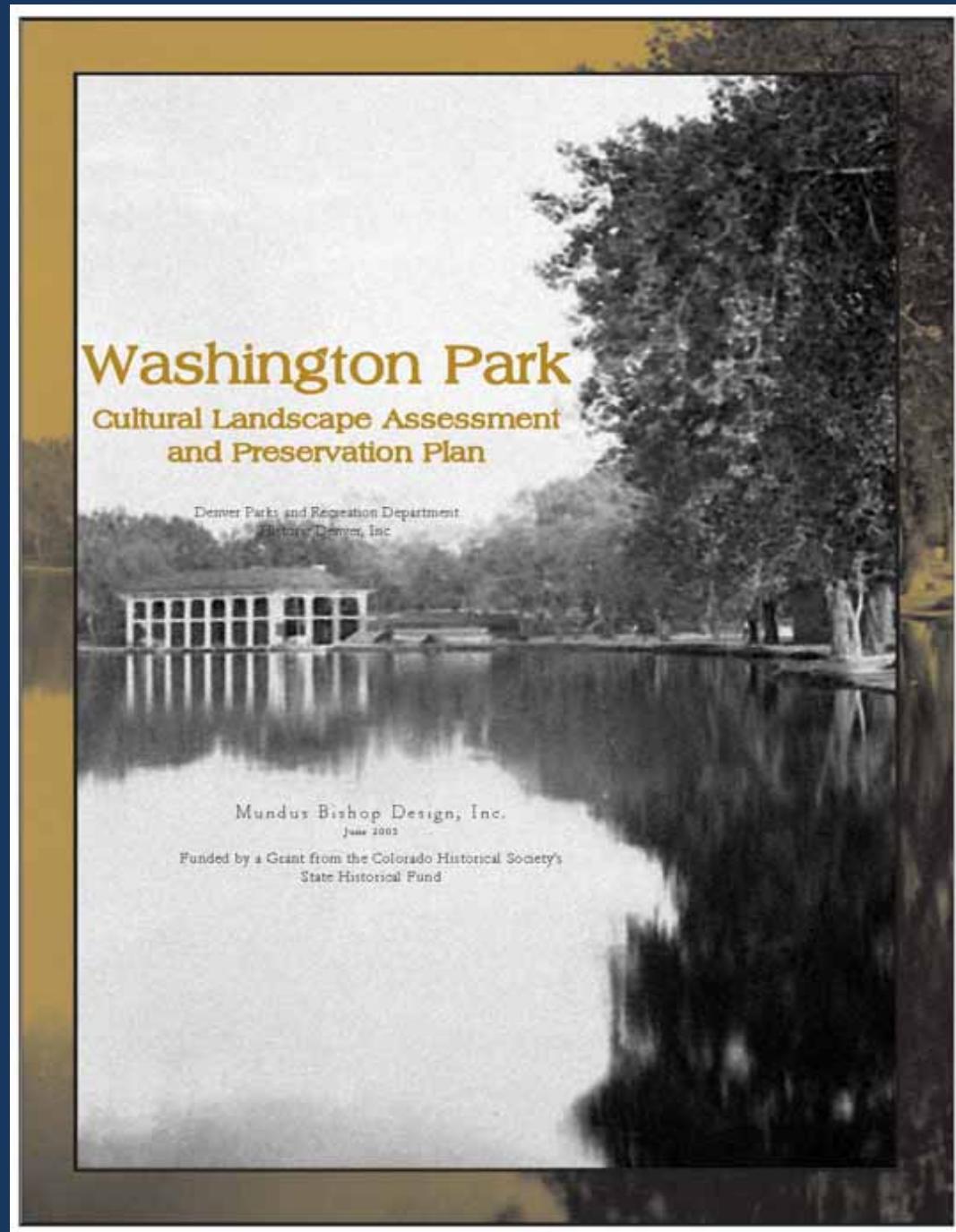



Scenic Park with picturesque setting and distinct Rocky Mountain Views

**‘New Landscape Style’
Use of topography & trees to create spaces and views**

**One of the Denver’s main
Civic Spaces**

**Six contributing design
periods since 1899**



User Survey

- Popular Activities
 - Concerns
 - What Should be Improved?
-
- 1,000 on-site interviews in September 2009
 - 300 online follow ups in October 2009
 - Statistically valid results

Washington Park User Survey
Summer/Fall 2009

NOVEMBER 2009



Prepared for:
Wenk Associates, Inc.
City and County of Denver

Prepared by:
RRC Associates, Inc.
4940 Pearl East Circle, Ste 103
Boulder, CO 80301
303/449-6558

Key Survey Findings

Most Popular Activities:

- Walking
- Visiting Playground
- Hanging Out
- Recreational Cycling
- Jogging
- Walk/Play with Dog
- Picnicking
- Visiting Flower Gardens
- Watching Wildlife



Most Important Concerns:

- Parking Closer to Activities
- Conflicts between Vehicles & other users
- High Speed Cyclists & Rollerbladers
- Non-cyclists in Bike Lanes
- Off-leash Dogs
- Lack of Food Vendors
- Lack of Ranger Presence
- Geese Population

Planning Process

- Community Outreach
- Inventory and Assessment
- Concept Alternatives
- Plan Refinement
- Project Planning & Prioritization

3 Public Meetings
10 Stakeholder
Meetings



Basis for Recommendations

- Preserve and Restore the Park's Historic Character
 - Preserve Historic Landscapes
 - Identify appropriate uses for Historic Structures
 - Rehabilitate Historic Features
- Provide a Positive Recreation Experience for Visitors
 - Balance active and passive uses
 - Update recreation facilities
 - Reduce conflicts
- Implement Environmentally Sustainable Practices
 - Reduce Water and Energy Use
 - Improve Lake Ecosystems
 - Improve Park Landscape & Habitat

Basis for Recommendations

- Areas of Preservation
- Areas of Rehabilitation
- Areas of Flexibility

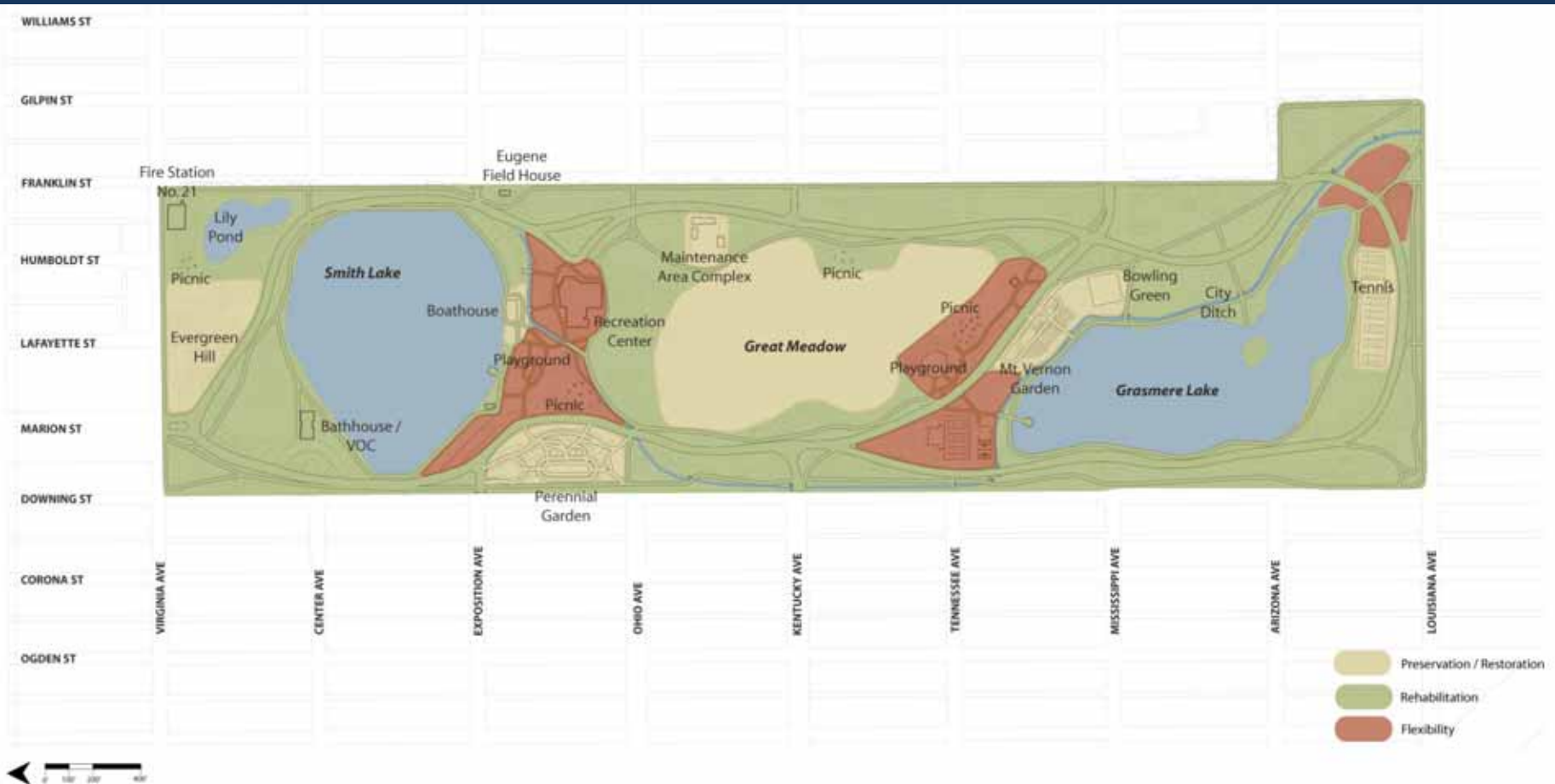

Areas of Preservation

■ Implement the Preservation Plan

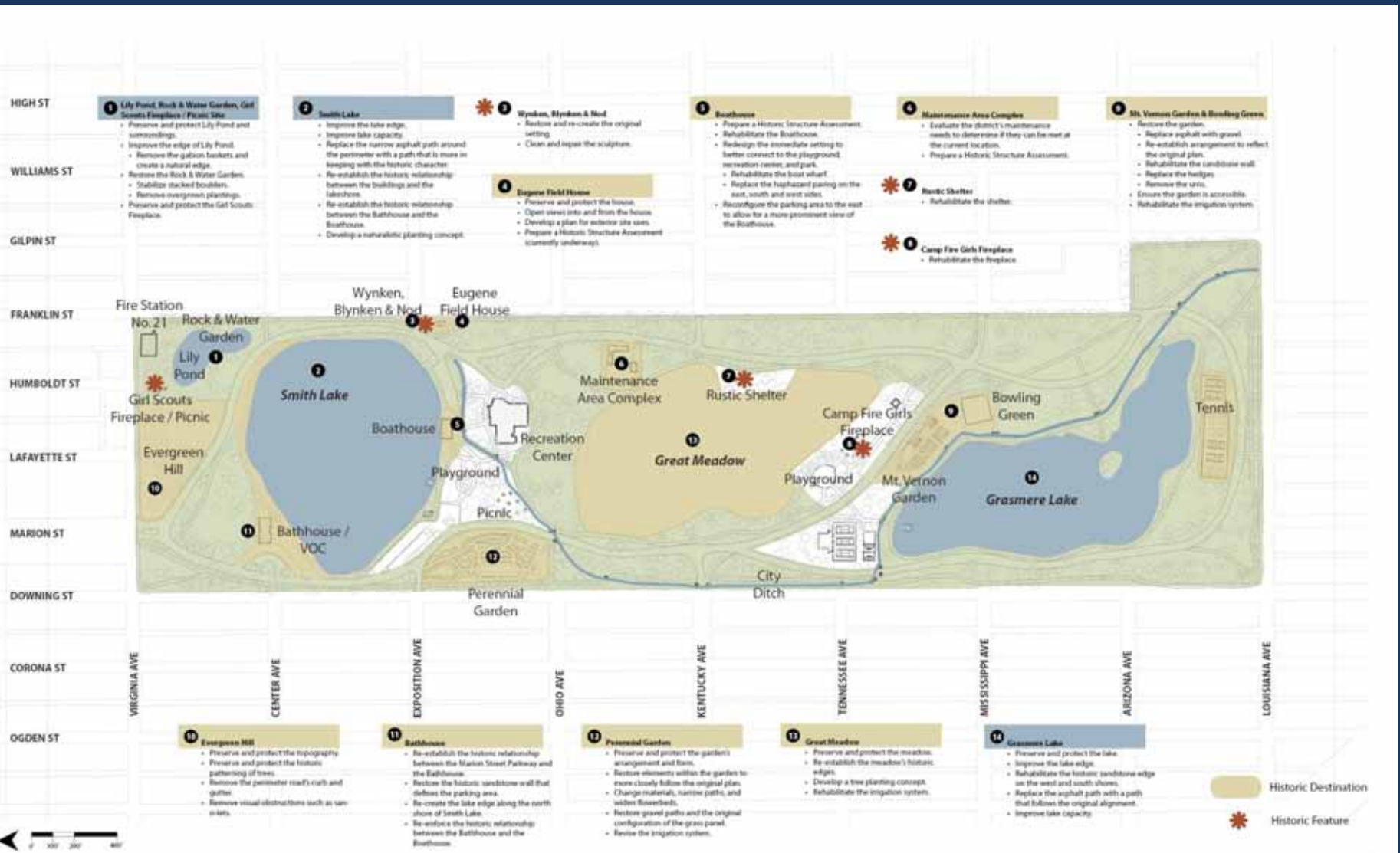

Areas of Rehabilitation

- Lakes and Lake Edges



Areas of Rehabilitation

- Improve Circulation



Rehabilitate the Loop Road



Improve Parking

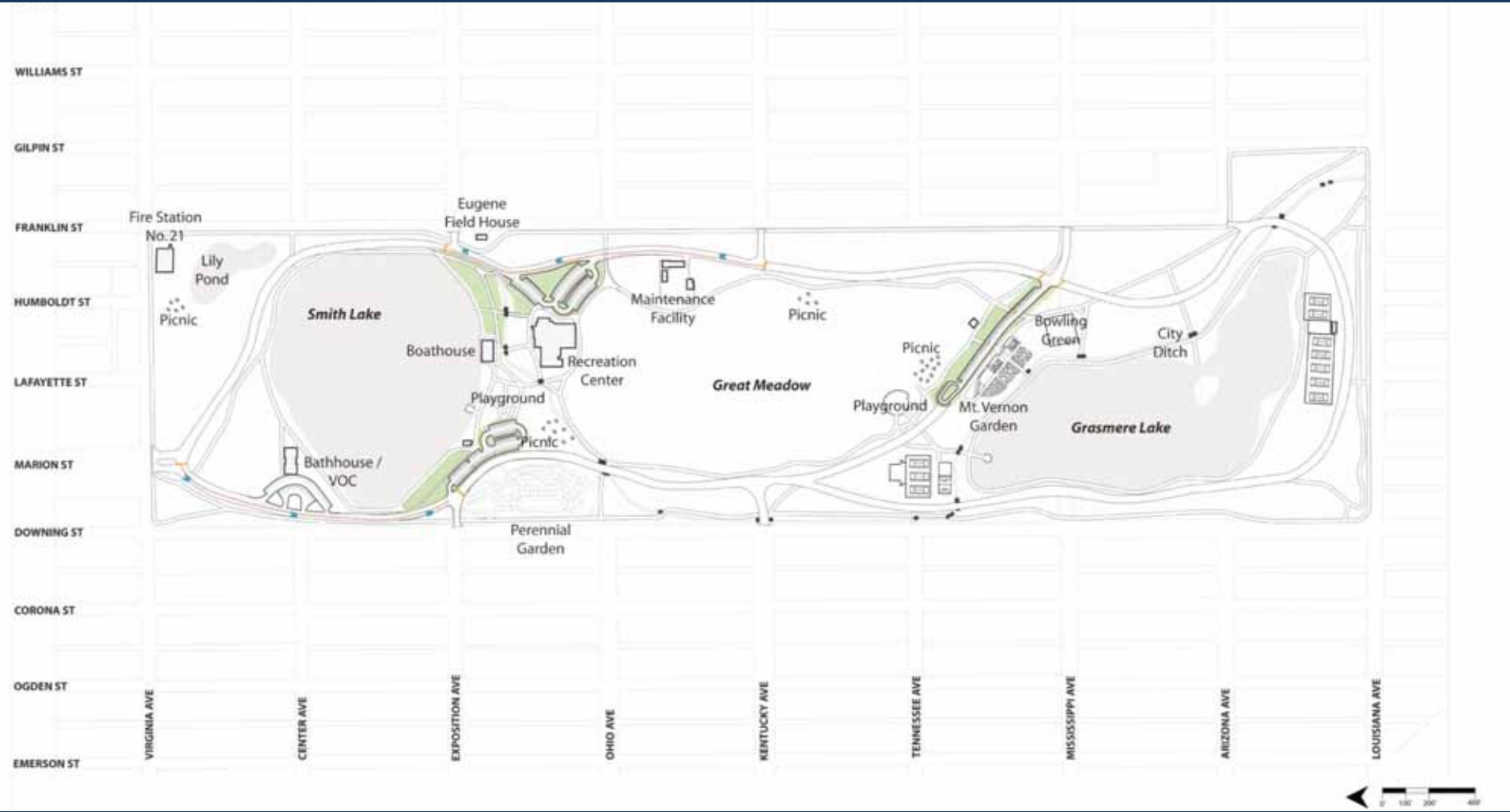

Improve Park Access



Areas of Rehabilitation

■ Park Roads, Trails and Paths - Hierarchy



Areas of Rehabilitation

- Wooded Perimeter and Naturalized Meadows



Areas of Flexibility

- Boathouse Terrace
- Diagonal
- South Portal

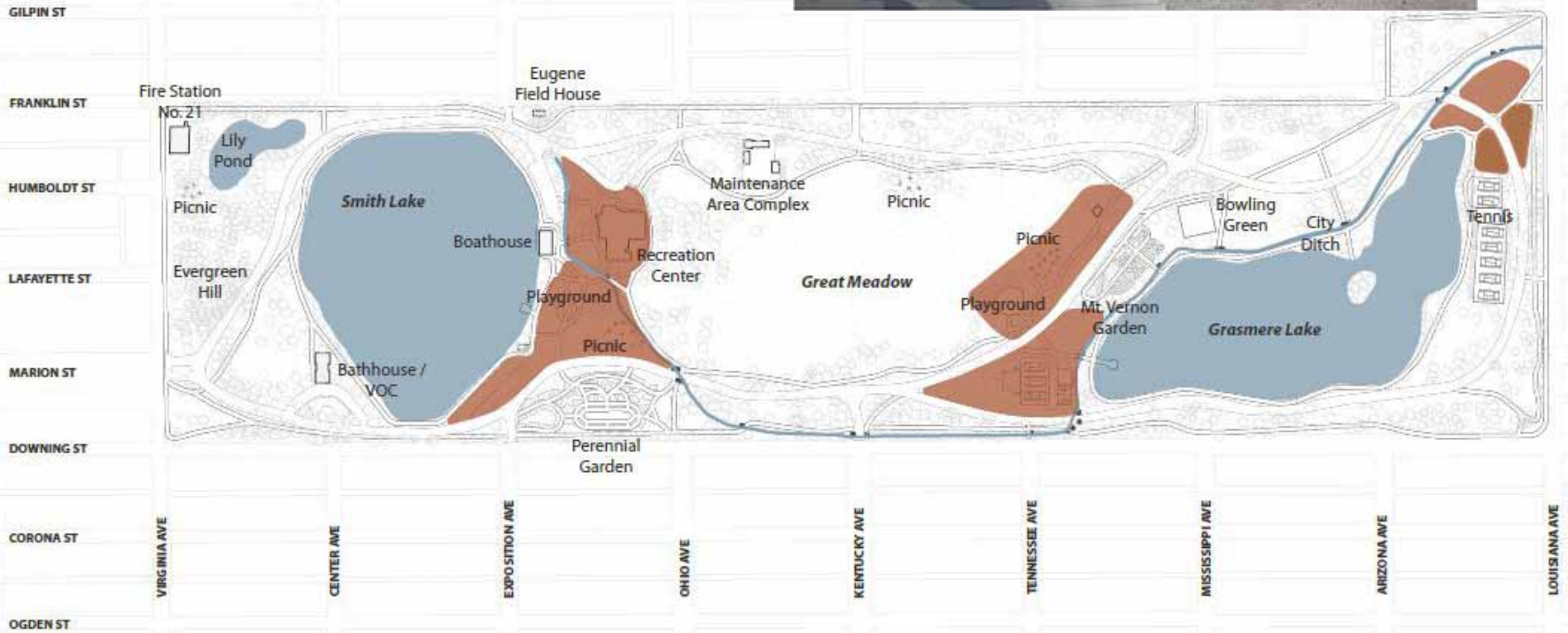

Boat House Terrace Current View



Boat House Terrace Renovation

- Relocate parking
- Renovate Terrace
- Improve Amenities
- Renovate Picnic Area
- Restore Wynken, Blynken and Nod Water Feature

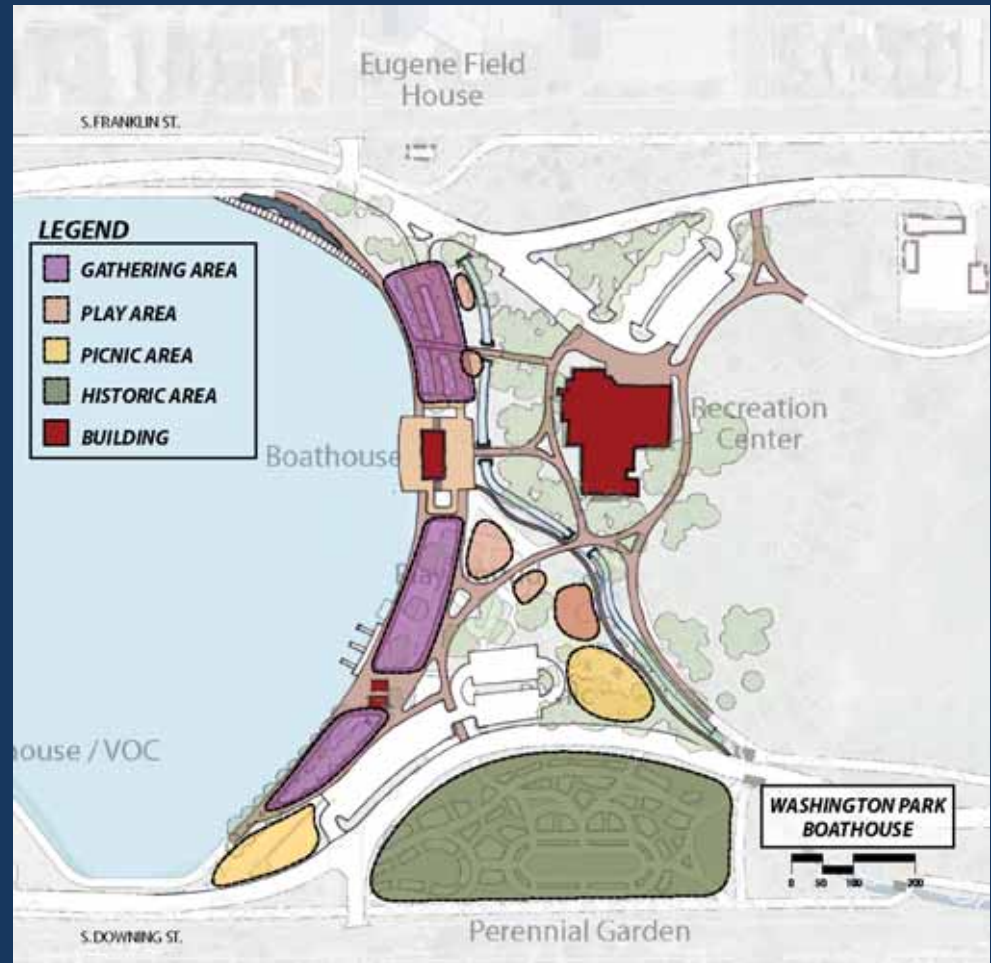

Boat House Terrace Concept



Diagonal

- Upgrade Picnic Area
- Add Youth Recreation
- Build Regional Playground

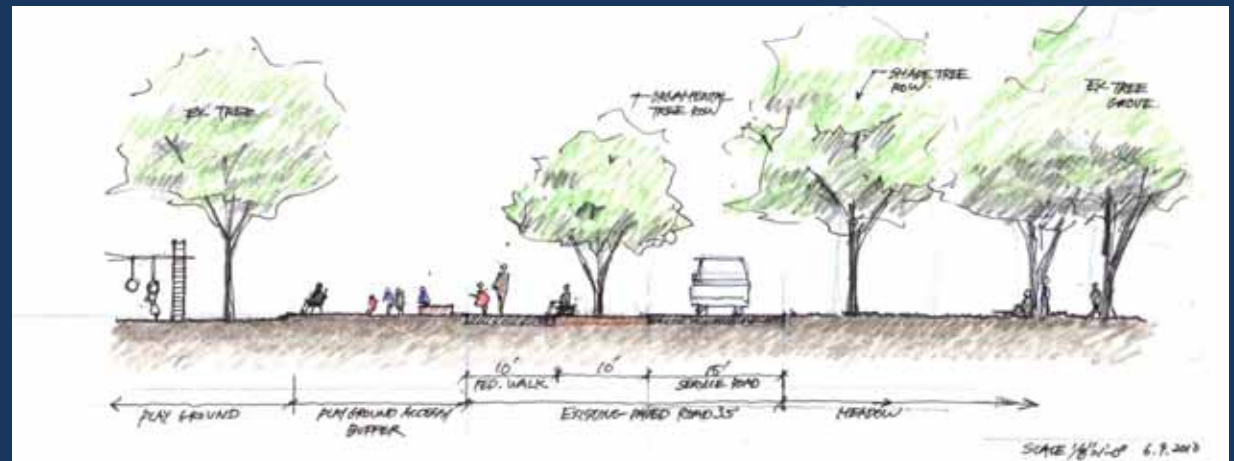
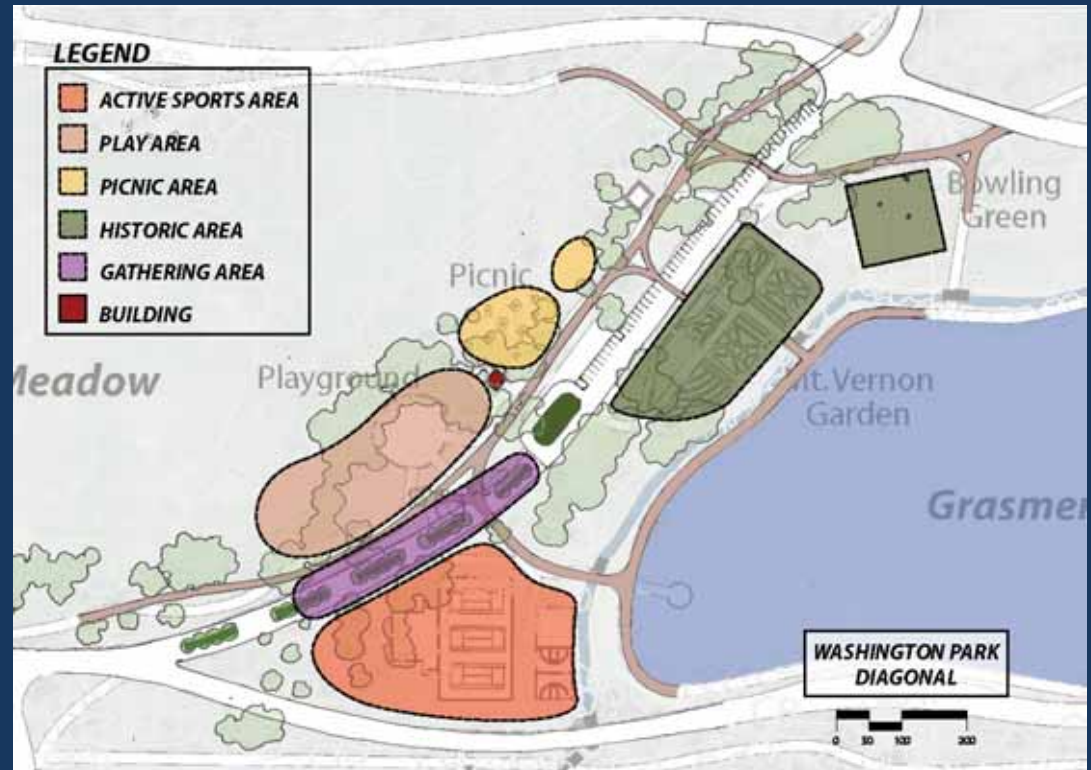

South Portal

- Renovate Park Entrance
- Accommodate Use Areas
- Encourage Parking at South High



General Planning Guidelines

- Design Requirements
 - Public Process
- Recreation Programming
- Park Support Services
- Park Management
 - Access
 - Safety
 - Maintenance
- Funding



Improvement Priorities

Diagonal improvements

- Picnic site
- Parking layout
- Road/turn around layout
- Regional playground
- Youth play area

South Entry Gateway

- Pedestrian crossing at Louisiana
- Entry plaza w. kiosk
- Pathway connection to loop road
- Ditch repairs at this reach

Boathouse area

- Upper boathouse terrace & city ditch
- Lower boathouse terrace
- Smith Lake Promenade and lake shore
- Play areas and gathering spaces
- West parking lot
- East parking lot
- Completion of ditch repairs

Circulation

- Loop Road Striping
- Pedestrian trail alignment & renovation
- Running path
- Park entry areas

Landscape areas

- Turf conversion
- Wetlands
- Shrub plantings
- Trees
- Irrigation

Other park amenities

- Picnic sites
- Eugene Field House
- Concessions/Services

2011 Proposed Projects

- Irrigation Automation @ Downing Ditch Repair Project
- Running Trail Upgrades
- Diagonal Area Renovation
- Loop Road
- South Park Entry Gateway
- South Tennis Court Shelter
- Exposition Flower Garden Pathway Renovation
- Grasmere Lake Wetland Renovation
- Downing Pedestrian Crossings
- Tree Management/Pruning

**Funded through:
CIP, Citywide Maintenance, Donations,
Partnerships, Grants, Other Agencies**

Questions?

